

BUKH™ ANODES

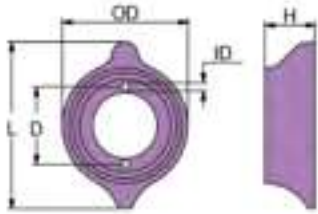

	PID	LB	KG		OD	L	H	D	ID	UPC
Al	CMB00E5829A	0.729	0.330	mm	107	140	43	68	7	6 28309 19260 0
Mg	CMB00E5829M	0.462	0.209							6 28309 19304 1
Zn	CMB00E5829Z	1.900	0.862	in	4.2	5.5	1.7	2.66	0.27	6 28309 12201 0

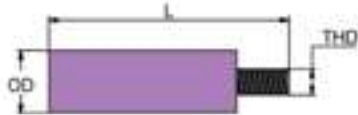

	PID	LB	KG		OD	L	THD	UPC
Al	CMB00E0450A	0.033	0.015	mm	12	46	M5 x 0.8	6 28309 23559 8
Mg	CMB00E0450M	0.024	0.011					6 28309 23560 4
Zn	CMB00E0450Z	0.066	0.030	in	0.5	1.8		6 28309 12182 2

CASTOLDI™ ANODES

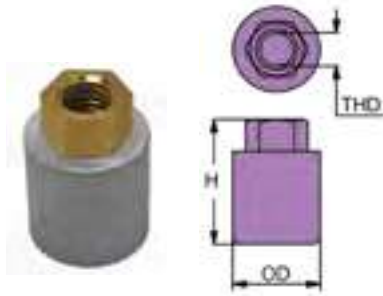

	PID	LB	KG		OD	H	THD	UPC
Al	CM590140552A	0.086	0.039	mm	22	30	M10 x 1.5	6 28309 21156 1
Mg	CM590140552M	0.072	0.033					6 28309 21156 1
Zn	CM590140552Z	3.185	0.063	in	0.9	1.2		6 28309 21132 5

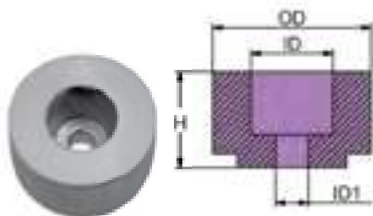

	PID	LB	KG		OD	H	ID	ID1	UPC
Al	CM590163243A	0.43	0.196	mm	58	35	25	9	6 28309 23386 0
Mg	CM590163243M	0.27	0.124						6 28309 23387 7
Zn	CM590163243Z	1.12	0.51	in	2.28	1.38	0.98	0.36	6 28309 23388 4
Al	CM59066209A	0.086	0.039	mm	80	50	30	10.2	6 28309 23389 1
Mg	CM59066209M	0.072	0.033						6 28309 23390 7
Zn	CM59066209Z	3.185	1.445	in	3.15	1.97	1.18	0.4	6 28309 23391 4

HIDEA™ ANODES

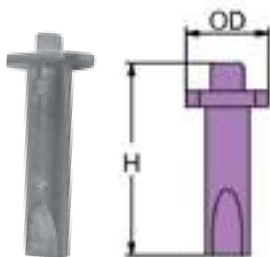

	PID	LB	KG		OD	H	UPC
Al	CM6J81132500A	0.011	0.005	mm	16	41	6 28309 19537 3
Mg	CM6J81132500M	0.006	0.003				6 28309 19538 0
Zn	CM6J81132500Z	0.028	0.013	in	0.63	1.61	6 28309 19539 7

ALSO APPLY TO PAINIER

Martyr®
BUKH™ / CASTOLDI™ / HIDEA™ ANODES

HONDA™ ANODES

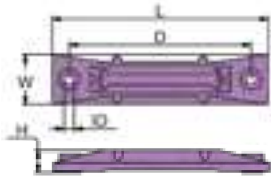

	PID	LB	KG		L	W	H	D	ID	UPC
Al	CM06411ZV5A	0.31	0.14	mm	150	36	16	126	7	6 28309 17552 8
Mg	CM06411ZV5M	0.2	0.09							6 28309 17043 1
Zn	CM06411ZV5Z	0.79	0.36	in	5.9	1.4	0.6	4.9	0.3	6 28309 11373 5

40/50 HP

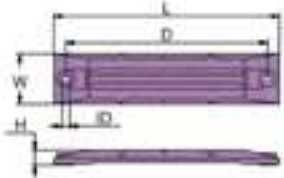

	PID	LB	KG		L	W	H	D	ID	UPC
Al	CM06411ZW1A	0.70	0.32	mm	226	50	16	202	7	6 28309 17554 2
Mg	CM06411ZW1M	0.44	0.20							6 28309 17041 7
Zn	CM06411ZW1Z	1.81	0.82	in	8.8	2	0.6	7.9	0.3	6 28309 11374 2

75 / 130 / 225 HP

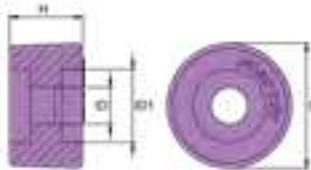

	PID	LB	KG		OD	ID	ID1	H	UPC
Al	CM12155ZW5000A	0.0256	0.0116	mm	24	7	14	14	6 28309 26268 6
Mg	CM12155ZW5000M	0.0164	0.00743						6 28309 26269 3
Zn	CM12155ZW5000Z	0.0672	0.0305	in	0.94	0.28	0.55	0.55	6 28309 26270 0

75 / 90 / 130 HP

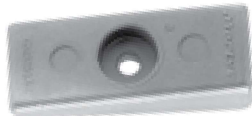
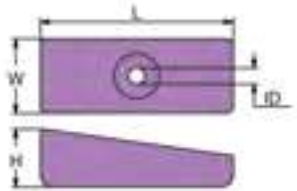

	PID	LB	KG		L	W	H	ID	UPC
Al	CM41109ZW1003A (CM826134A)	0.209	0.095	mm	76	30	23	6	6 28309 24168 1
Mg	CM41109ZW1003M (CM826134M)	0.130	0.059						6 28309 24274 9
Zn	CM41109ZW1003Z (CM826134Z)	0.542	0.246	in	3	1.16	0.9	0.24	6 28309 24102 5

75 HP - V6 40/50 /115 EFI 4T

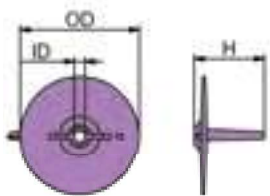

	PID	LB	KG		OD	H	ID	UPC
Al	CM6644537101A	0.238	0.108	mm	96	57	9	6 28309 12643 8
Mg	CM6644537101M	0.154	0.070					6 28309 10064 3
Zn	CM6644537101Z	0.639	0.290	in	3.8	2.2	0.33	6 28309 10065 0

MARINER 10 - 50 HP YAMAHA 20 - 25 - 30 - 40 - 50 HP

HONDA™ ANODES