

Choose
Aluminum

Al premium
SALT AND BRACKISH WATER

Anodes for
salt and brackish
water and
Magnesium

Mg fresh
FRESH WATER ONLY

for freshwater.

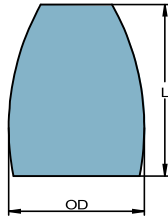

REPLACEMENT PROPELLER NUT ANODES

TYPE	PID	LB	KG		L	OD	UPC	
Al	A	CMPNAA	0.081	0.037	mm	38	32	6 28309 11813 6
Mg		CMPNMA	0.057	0.026				
Zn		CMPNZA	0.218	0.099	in	1.5	1.25	6 28309 11357 5
Al	B	CMPNAB	0.192	0.087	mm	52	42	6 28309 11814 3
Mg		CMPNMB	0.128	0.058				
Zn		CMPNZB	0.513	0.233	in	2.05	1.65	6 28309 10871 7
Al	C	CMPNAC	0.436	0.198	mm	67	51	6 28309 11815 0
Mg		CMPNMC	0.273	0.124				
Zn		CMPNZC	1.124	0.510	in	2.64	2	6 28309 11359 9
Al	D	CMPNAD	1.389	0.630	mm	75	58	6 28309 11816 7
Mg		CMPNMD	0.904	0.410				
Zn		CMPNZD	3.637	1.650	in	2.95	2.3	6 28309 10873 1
Al	E	CMPNAE	0.710	0.322	mm	79	64	6 28309 11532 6
Mg		CMPNME	0.450	0.204				
Zn		CMPNZE	1.790	0.812	in	3.13	2.5	6 28309 11361 2
Al	F	CMPNAF	0.782	0.355	mm	84	70	6 28309 11817 4
Mg		CMPNMF	0.527	0.239				
Zn		CMPNZF	2.068	0.938	in	3.32	2.75	6 28309 11362 9
Al	G	CMPNAG	1.109	0.503	mm	88	79	6 28309 12216 4
Mg		CMPNMG	0.747	0.339				
Zn		CMPNZG	2.934	1.331	in	3.46	3.13	6 28309 11363 6
Al	H	CMPNAH	1.230	0.558	mm	98	85	6 28309 12217 1
Mg		CMPNMH	0.774	0.351				
Zn		CMPNZH	3.207	1.455	in	3.84	3.34	6 28309 10875 5
								6 28309 10874 8
								6 28309 10876 2
								6 28309 10877 9
								6 28309 11364 3
								6 28309 10878 6

IMPORTANT PROP NUT FASTENERS:

- Fasteners are included with all replacement prop nuts.
- Nylon patch is good for one initial application only.
- Please use lock tite or teflon tape to ensure maximum hold.

Martyr
PROPELLER ANODES

AUTOPROP™ ANODES

	PID	LB	KG		H	OD	ID	D	ID1	UPC
Al	CMPNH5A	0.125	0.057	mm	33	57	28.6	40.7	6.9	6 28309 24242 8
Mg	CMPNH5M	0.079	0.036							
Zn	CMPNH5Z	0.330	0.150	in	1.3	2.24	1.13	1.6	0.27	6 28309 24364 7
Al	CMPNH6A	0.308	0.140	mm	46	74	29.6	49.4	8.8	6 28309 17089 9
Mg	CMPNH6M	0.194	0.088							
Zn	CMPNH6Z	0.804	0.365	in	1.81	2.91	1.17	1.94	0.35	6 28309 24243 5
										6 28309 24365 4
										6 28309 17090 5

	PID	LB	KG		OD	H	D	ID	ID1	UPC
Al	CMPNH9A	0.425	0.193	mm	89	46	62.18	40	11	6 28309 25524 4
Mg	CMPNH9M	0.269	0.122							
Zn	CMPNH9Z	1.106	0.502	in	3.50	1.81	2.45	1.57	0.43	6 28309 25529 9
										6 28309 25519 0

AUTOPROP 3-BLADE PROPELLER H9

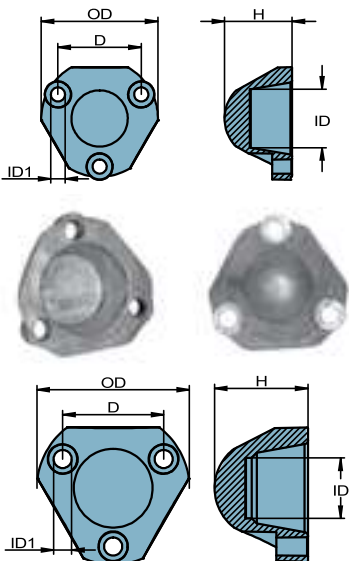

BENETEAU™ ANODES / incl. insert & hardware

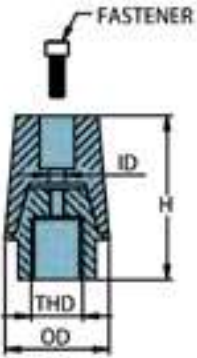
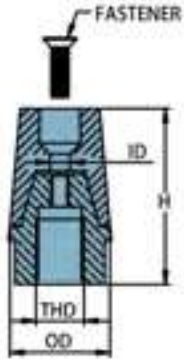

Prop Nut Complete		PID	LB	KG		OD	ID	H	THD	Fastener countersink socket head w/pitch	UPC
Al	22/25 mm	CMLAEC3250A	0.465	0.211	mm	34	6.9	59	M16 x 1.5	M6 x 20 SS	6 28309 24214 5
Mg		CMLAEC3250M	0.425	0.193	in	1.32	0.27	2.31			6 28309 24343 2
Zn		CMLAEC3250	0.646	0.293							6 28309 11315 5
Al	30mm	CMLAEC3300A	0.853	0.387	mm	42	8.1	77	M20 x 1.5	M8 x 30 SS	6 28309 24215 2
Mg		CMLAEC3300M	0.767	0.348	in	1.65	0.32	3.04			6 28309 24344 9
Zn		CMLAEC3300	1.228	0.557							6 28309 11316 2
Al	35mm	CMLAEC3500A	1.096	0.497	mm	46	8.1	83	M24 x 2	M8 x 30 SS	6 28309 24216 9
Mg		CMLAEC3500M	0.989	0.449	in	1.81	0.32	3.25			6 28309 24345 6
Zn		CMLAEC3500	1.565	0.710							6 28309 11317 9
Al	40mm	CMLAEC4000A	1.591	0.722	mm	51	8.1	95	M24 x 2	M8 x 30 SS	6 28309 24217 6
Mg		CMLAEC4000M	1.442	0.654	in	2.02	0.32	3.73			6 28309 24346 3
Zn		CMLAEC4000	2.293	1.040							6 28309 11318 6
Al	45mm	CMLAEC4500A	2.467	1.119	mm	61	10.4	108	M30 x 2	M10 x 30 SS	6 28309 24218 3
Mg		CMLAEC4500M	2.207	1.001	in	2.40	0.41	4.24			6 28309 24347 0
Zn		CMLAEC4500	3.576	1.622							6 28309 11319 3
Al	45mm	CMLAEC4500EUA	2.237	1.015	mm	59	10.5	103.3	M33 x 2	M10 x 25 SS	6 28309 21165 3
Mg		CMLAEC4500EUM	1.995	0.905	in	2.32	0.41	4.01			6 28309 21193 6
Zn		CMLAEC4500EUZ	3.185	1.445							6 28309 21143 1
Al	50mm	CMLAEC5000A	3.589	1.628	mm	71	12	117	M36 x 3	M10 x 30 SS	6 28309 19266 2
Mg		CMLAEC5000M	3.214	1.458	in	2.8	0.47	4.61			6 28309 19305 8
Zn		CMLAEC5000	5.330	2.418							6 28309 18203 8
Al	55mm	CMLAEC5500A	4.140	1.878	mm	72	11	118.5	M40 x 3	M10 x 30 SS	6 28309 19267 9
Mg		CMLAEC5500M	3.765	1.708	in	2.83	0.43	4.67			6 28309 19306 5
Zn		CMLAEC5500	5.573	2.528							6 28309 18204 5
Al	60mm	CMLAEC6000A	6.036	2.738	mm	81	11	136	M45 x 3	M10 x 30 SS	6 28309 19268 6
Mg		CMLAEC6000M	5.463	2.478	in	3.19	0.43	5.35			6 28309 19307 2
Zn		CMLAEC6000	8.263	3.748							6 28309 18205 2
Al	100mm	CMLAEC10000A	9.645	4.375	mm	99	11	144	M50 x 3	M10 x 30 SS	6 28309 23713 4
Mg		CMLAEC10000M	8.895	4.035	in	3.90	0.43	5.67			6 28309 23714 1
Zn		CMLAEC10000	12.934	5.867							6 28309 23712 7

PROPELLER ANODES

BENETEAU™ REPLACEMENT ANODES

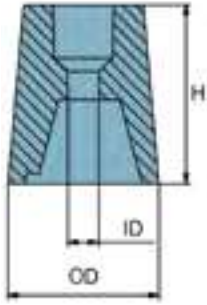

Prop Nut Replace		PID	LB	KG		H	OD	ID	UPC
Al	22/ 25mm	CMAN225A	0.111	0.050	mm	39	34	7	6 28309 19168 9
Mg		CMAN225M	0.071	0.032	in	1.55	1.32	0.27	6 28309 19324 9
Zn		CMAN225	0.290	0.131					6 28309 11308 7
Al	30mm	CMAN230A	0.230	0.104	mm	54	42	8	6 28309 19169 6
Mg		CMAN230M	0.146	0.066	in	2.11	1.65	0.32	6 28309 19325 6
Zn		CMAN230	0.600	0.272					6 28309 11309 4
Al	35mm	CMAN235A	0.289	0.131	mm	58	46	8	6 28309 19170 2
Mg		CMAN235M	0.183	0.083	in	2.28	1.81	0.32	6 28309 19326 3
Zn		CMAN235	0.758	0.344					6 28309 11310 0
Al	40mm	CMAN240A	0.419	0.190	mm	67	51	8	6 28309 19171 9
Mg		CMAN240M	0.269	0.122	in	2.62	2.02	0.32	6 28309 19327 0
Zn		CMAN240	1.119	0.508					6 28309 11311 7
Al	45mm	CMAN245A	0.690	0.313	mm	76	61	10	6 28309 19172 6
Mg		CMAN245M	0.430	0.195	in	2.99	2.4	0.40	6 28309 19328 7
Zn		CMAN245	1.800	0.816					6 28309 11312 4
Al	45mm	CMAN245EUA	0.66	0.30	mm	74	59	10.5	6 28309 21164 6
Mg		CMAN245EUM	0.42	0.19	in	2.9	2.3	0.41	6 28309 21188 2
Zn		CMAN245EUZ	1.61	0.73					6 28309 21140 0
Al	50mm	CMAN250A	1.014	0.460	mm	84	71	12	6 28309 19329 4
Mg		CMAN250M	0.639	0.290	in	3.3	2.8	0.5	6 28309 19330 0
Zn		CMAN250	1.909	0.866					6 28309 18004 1
Al	55mm	CMAN255A	0.99	0.45	mm	84	72	11	6 28309 19331 7
Mg		CMAN255M	0.62	0.28	in	3.3	2.8	0.4	6 28309 19332 4
Zn		CMAN255	2.47	1.12					6 28309 18005 8
Al	60mm	CMAN260A	1.57	0.71	mm	96	81	11	6 28309 19333 1
Mg		CMAN260M	0.99	0.45	in	3.8	3.2	0.4	6 28309 19334 8
Zn		CMAN260	3.88	1.76					6 28309 18006 5
Al	70mm	CMANCHN700A	1.345	0.610	mm	100	83	9	6 28309 12536 3
Mg		CMANCHN700M	0.857	0.389	in	3.94	3.27	0.35	6 28309 24298 5
Zn		CMANCHN700	3.527	1.600					6 28309 12535 6

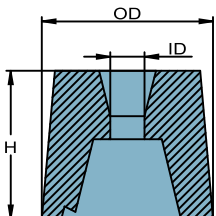
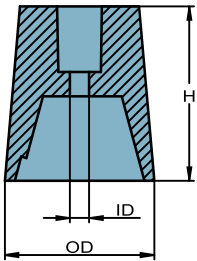

Martyr®
PROPELLER ANODES

FERRETTI™ ANODES

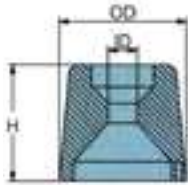

	PID	LB	KG		H	OD	ID	UPC
Al	CMFE1A	0.42	0.19	mm	65	50	10	6 28309 23634 2
Mg	CMFE1M	0.26	0.12					6 28309 23635 9
Zn	CMFE1Z	1.10	0.50	in	2.6	2	0.38	6 28309 23636 6

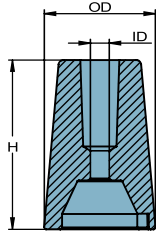

	PID	LB	KG		H	OD	ID	UPC
Al	CMFE2A	0.86	0.39	mm	90	59	10	6 28309 23637 3
Mg	CMFE2M	0.55	0.25					6 28309 23638 0
Zn	CMFE2Z	2.25	1.02	in	3.5	2.3	0.38	6 28309 23639 7

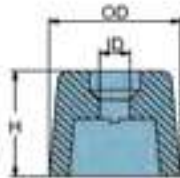

	PID	LB	KG		H	OD	ID	UPC
Al	CMFE3A	0.46	0.21	mm	65	50	7	6 28309 23640 3
Mg	CMFE3M	0.28	0.13					6 28309 23641 0
Zn	CMFE3Z	1.19	0.54	in	2.6	2	0.28	6 28309 23642 7

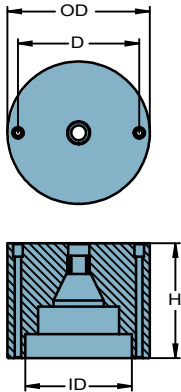

	PID	LB	KG		H	OD	D	iD	UPC
Al	CMFE80A	10.82	4.91	mm	125	155	132	116	6 28309 23649 6
Mg	CMFE80M	6.9	3.13						6 28309 23650 2
Zn	CMFE80Z	26.45	12	in	4.9	6.1	5.2	4.6	6 28309 23651 9

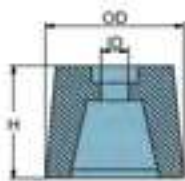

	PID	LB	KG		H	OD	ID	UPC
Al	CMFE4A	0.77	0.35	mm	75	60	10	6 28309 23643 4
Mg	CMFE4M	0.48	0.22					6 28309 23644 1
Zn	CMFE4Z	2.00	0.91	in	2.9	2.4	0.4	6 28309 23645 8

PROPELLER ANODES