

Choose
Aluminum

Al premium
SALT AND BRACKISH WATER ◆

anodes for
salt and brackish
water and
Magnesium

Mg fresh
FRESH WATER ONLY ◆

for freshwater.

STREAMLINED SHAFT ANODES / imperial

SHAFT & RUDDER ANODES

Easy installation underwater.

Bolt retaining washers prevent the anode from falling off. Choose from two of our stainless steel hardware options:



Allen head w/ lock washer & bolt retaining washer



Slotted head w/ lock washer & bolt retaining washer (add S to the PID)

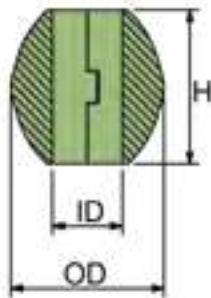

CMX00-CMX09

- Interlocking halves

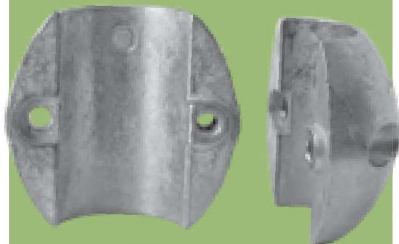

- Full shaft contact (100% CIRCULAR RADIUS)
- Extra alloy around fastener

	PID	LB	KG		H	OD	ID	UPC
Al	CMX00A	0.126	0.098	mm	50	42	12	6 28309 24256 5
Mg	CMX00M	0.145	0.066					6 28309 18277 9
Zn	CMX00	0.525	0.238	in	1.95	1.64	0.5	6 28309 12220 1
Al	CMX01AL	0.31	0.14	mm	51	52	19	6 28309 12752 7
Mg	CMX01M	0.22	0.10					6 28309 12771 8
Zn	CMX01	0.85	0.38	in	2	2.04	0.75	6 28309 10365 1
Al	CMX018125AL	0.31	0.14	mm	50.8	51.8	20.63	6 28309 12751 0
Zn	CMX018125	0.75	0.34	in	2	2.04	0.8125	6 28309 12350 5
Al	CMX02AL	0.34	0.15	mm	53	54	22.22	6 28309 12753 4
Mg	CMX02M	0.25	0.11					6 28309 12772 5
Zn	CMX02	0.95	0.43	in	2.08	2.12	0.875	6 28309 10366 8
Al	CMX03AL	0.36	0.16	mm	55	55	25	6 28309 12626 1
Mg	CMX03M	0.25	0.11					6 28309 11534 0
Zn	CMX03	1	0.45	in	2.15	2.16	1	6 28309 10367 5
Al	CMX04AL	0.43	0.19	mm	57	60	28.57	6 28309 12755 8
Mg	CMX04M	0.3	0.13					6 28309 12773 2
Zn	CMX04	1.16	0.526	in	2.25	2.36	1.125	6 28309 10368 2
Al	CMX05AL	0.46	0.208	mm	60	61	32	6 28309 12756 5
Mg	CMX05M	0.3	0.13					6 28309 11535 7
Zn	CMX05	1.18	0.535	in	2.35	2.42	1.25	6 28309 10369 9
Al	CMX05AAL	0.71	0.32	mm	62	68	32	6 28309 24257 2
Mg	CMX05AM	0.47	0.21					6 28309 24386 9
Zn	CMX05A	1.75	0.79	in	2.45	2.68	1.25	6 28309 10370 5
Al	CMX06AL	0.58	0.263	mm	60	67	34.92	6 28309 12757 2
Mg	CMX06M	0.38	0.17					6 28309 12774 9
Zn	CMX06	1.50	0.680	in	2.35	2.66	1.375	6 28309 10371 2
Zn	CMX0625	0.70	0.32	mm	50.8	48.76	15.87	6 28309 15714 2
				in	2	1.92	0.625	
Al	CMX07AL	0.66	0.299	mm	63	70	38	6 28309 12758 9
Mg	CMX07M	0.42	0.19					6 28309 12775 6
Zn	CMX07	1.70	0.771	in	2.5	2.78	1.5	6 28309 10372 9
Al	CMX08AL	0.95	0.43	mm	73	82	44	6 28309 12759 6
Mg	CMX08M	0.64	0.29					6 28309 12776 3
Zn	CMX08	2.4	1.09	in	2.75	3.25	1.75	6 28309 10373 6
Al	CMX09AL	1.17	0.53	mm	73	82	51	6 28309 12760 2
Mg	CMX09M	0.80	0.36					6 28309 12777 0
Zn	CMX09	2.97	1.347	in	2.9	3.6	2	6 28309 10374 3

Protect your boat, respect our waters.

Choose
Aluminum

Al premium
SALT AND BRACKISH WATER

Anodes for
salt and brackish
water and
Magnesium

Mg fresh
FRESH WATER ONLY
for freshwater.

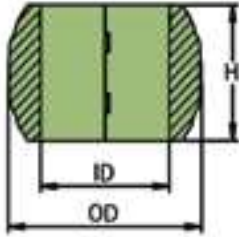

CMX10-CMX21

STREAMLINED SHAFT ANODES / imperial

PID		LB	KG		H	OD	ID	UPC
Al	CMX10AL	2.464	1.117	mm	95	106.1	57	6 28309 12761 9
Mg	CMX10M	1.608	0.729	in	3.75	4.18	2.25	6 28309 22963 4
Zn	CMX10	6.214	2.818					6 28309 10375 0
Al	CMX11AL	2.142	0.971					mm
Mg	CMX11M	1.404	0.637	in	3.75	4.18	2.5	6 28309 19129 0
Zn	CMX11	5.382	2.441					6 28309 10376 7
Al	CMX12AL	2.996	1.359					mm
Mg	CMX12M	1.964	0.891	in	3.625	4.8	2.75	6 28309 24387 6
Zn	CMX12	7.539	3.420					6 28309 10377 4
Al	CMX13AL	2.665	1.209					mm
Mg	CMX13M	1.752	0.795	in	3.625	4.8	3	6 28309 24388 3
Zn	CMX13	6.673	3.027					6 28309 10378 1
Al	CMX14A	2.87	1.30					mm
Mg	CMX14M	1.88	0.86	in	4.17	4.8	3.25	6 28309 23835 3
Zn	CMX14Z	7.21	3.27					6 28309 23836 0
Al	CMX15AL	3.642	1.652					mm
Mg	CMX15M	2.372	1.076	in	3.78	5.55	3.5	6 28309 24389 0
Zn	CMX15	9.211	4.178					6 28309 12232 4
Al	CMX17AL	3.51	1.59					mm
Mg	CMX17M	2.28	1.03	in	3.5	6	4.005	6 28309 24390 6
Zn	CMX17	8.91	4.04					6 28309 12223 2
Al	CMX18AL	4.859	2.204					mm
Mg	CMX18M	3.139	1.424	in	3.5	6.75	4.5	6 28309 24391 3
Zn	CMX18	12.420	5.634					6 28309 12793 0
Al	CMX19AL	3.648	1.655					mm
Mg	CMX19M	2.369	1.075	in	3.5	6.75	5	6 28309 24392 0
Zn	CMX19	9.270	4.205					6 28309 12794 7
Al	CMX20AL	6.230	2.826					mm
Mg	CMX20M	4.012	1.820	in	3.5	7.8	5.5	6 28309 23838 4
Zn	CMX20	15.957	7.238					6 28309 12795 4

Martyr®
SHAFT & RUDDER ANODES

The world's best shaft anode design:

- Fit & longevity
- Easy installation underwater: bolt retaining washers prevent the anode from falling off

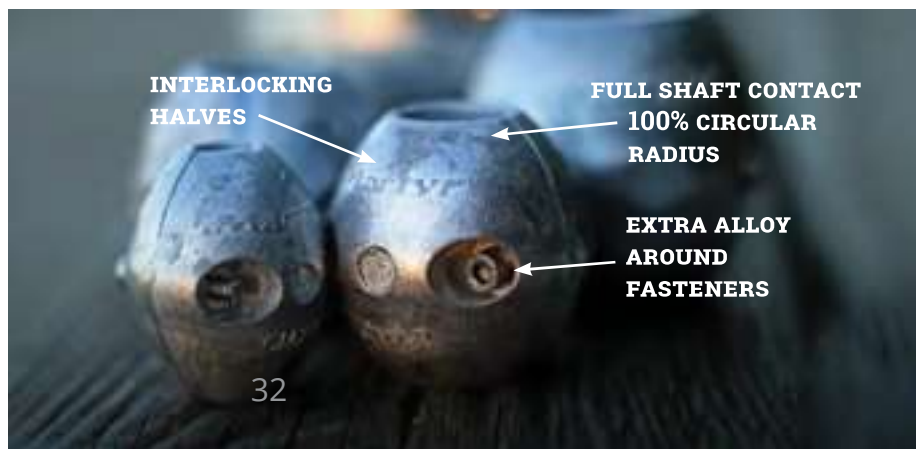

STREAMLINED SHAFT ANODES / imperial

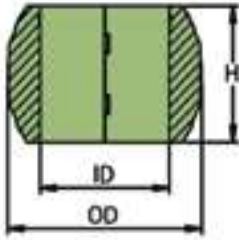

	PID	LB	KG		H	OD	ID	UPC
Al	CMX21AL	4.80	2.18	mm	89	198	152	6 28309 17582 5
Mg	CMX21M	3.10	1.40					6 28309 24393 7
Zn	CMX21	12.00	5.44	in	3.5	7.8	6	6 28309 12796 1

STREAMLINED SHAFT ANODES / metric

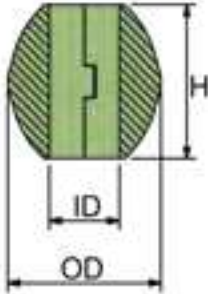

CMX00-CMX09

	PID	LB	KG		H	OD	ID	UPC
Al	CMXM20A	0.30	0.13	mm	48	51.2	20	6 28309 23863 6
Mg	CMXM20M	0.20	0.09					6 28309 23864 3
Zn	CMXM20Z	0.73	0.33	in	1.89	2.02	0.79	6 28309 23862 9
Al	CMX22A	0.279	0.127	mm	48	51.2	22	6 28309 23840 7
Mg	CMX22M	0.187	0.085					6 28309 23841 4
Zn	CMX22Z	0.685	0.311	in	1.89	2.01	0.86	6 28309 23842 1
Al	CMX25AL	0.480	0.217	mm	55	61	25	6 28309 12765 7
Mg	CMX25M	0.312	0.141					6 28309 24394 4
Zn	CMX25	1.216	0.551	in	2.17	2.40	1	6 28309 10379 8
Al	CMX28AL	0.51	0.23	mm	56	61	28	6 28309 23843 8
Mg	CMX28M	0.33	0.15					6 28309 23844 5
Zn	CMX28	1.28	0.58	in	2.20	2.40	1.10	6 28309 23845 2
Al	CMX30AL	0.486	0.220	mm	61	61	30	6 28309 12766 4
Mg	CMX30M	0.316	0.143					6 28309 12778 7
Zn	CMX30	1.228	0.557	in	2.40	2.40	1.18	6 28309 10380 4
Al	CMX34AL	0.68	0.31	mm	65	70	34	6 28309 21521 7
Mg	CMX34M	0.44	0.20					6 28309 21522 4
Zn	CMX34	1.73	0.79	in	2.60	2.75	1.34	6 28309 22962 7
Al	CMX35AL	0.630	0.285	mm	65	70	35	6 28309 12767 1
Mg	CMX35M	0.410	0.186					6 28309 12779 4
Zn	CMX35	1.610	0.730	in	2.62	2.75	1.38	6 28309 10381 1
Al	CMX40AL	1.222	0.554	mm	73	84	40	6 28309 12768 8
Mg	CMX40M	0.784	0.355					6 28309 12780 0
Zn	CMX40	3.152	1.429	in	2.87	3.30	1.57	6 28309 10382 8
Al	CMX45AL	1.082	0.490	mm	73	84	45	6 28309 12769 5
Mg	CMX45M	0.694	0.314					6 28309 12781 7
Zn	CMX45	2.782	1.262	in	2.87	3.30	1.77	6 28309 11530 2
Al	CMX50AL	0.924	0.419	mm	73	84	50	6 28309 12770 1
Mg	CMX50M	0.594	0.269					6 28309 12782 4
Zn	CMX50	2.370	1.075	in	2.87	3.30	2	6 28309 10383 5
Al	CMX55AL	2.41	1.09	mm	90	105	55	6 28309 19282 2
Mg	CMX55M	1.59	0.72					6 28309 22964 1
Zn	CMX55	6.03	2.73	in	3.54	4.13	2.17	6 28309 12821 0
Al	CMX60A	2.342	1.062	mm	95.25	106.2	60	6 28309 19335 5
Mg	CMX60M	1.536	0.696					6 28309 19343 0
Zn	CMX60	5.882	2.668	in	3.75	4.18	2.36	6 28309 12580 6

SHAFT & RUDDER ANODES

- Interlocking halves

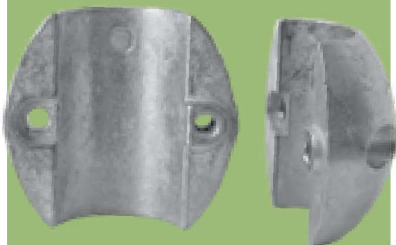

- Full shaft contact (100% CIRCULAR RADIUS)
- Extra alloy around fastener

Protect your boat, respect our waters.

STREAMLINED SHAFT ANODES / metric

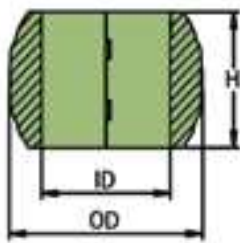

cmx55-cmx125

Martyr®

SHAFT & RUDDER ANODES



PID		LB	KG		H	OD	ID	UPC
Al	CMX65A	3.13	1.42	mm	90	120	65	6 28309 19336 2
Mg	CMX65M	2.04	0.92					6 28309 19344 7
Zn	CMX65	7.89	3.58	in	3.54	4.72	2.56	6 28309 12822 7
Al	CMX70A	3.046	1.382	mm	100	120	70	6 28309 19337 9
Mg	CMX70M	1.993	0.904					6 28309 19345 4
Zn	CMX70	7.681	3.484	in	3.94	4.72	2.76	6 28309 12823 4
Al	CMX75A	3.5	1.58	mm	100	125	75	6 28309 19338 6
Mg	CMX75M	2.3	1.04					6 28309 19346 1
Zn	CMX75	8.9	4.03	in	3.94	4.92	2.95	6 28309 12824 1
Al	CMX80A	3.65	1.65	mm	100	130	80	6 28309 19340 9
Mg	CMX80M	2.41	1.09					6 28309 19347 8
Zn	CMX80	9.18	4.16	in	3.94	5.12	3.15	6 28309 12825 8
Al	CMX85A	2.66	1.21	mm	106	122	85	6 28309 19339 3
Mg	CMX85M	1.74	0.79					6 28309 19348 5
Zn	CMX85Z	6.70	3.04	in	4.17	4.80	3.34	6 28309 23846 9
Al	CMX90A	4.32	1.96	mm	110	144	90	6 28309 19341 6
Mg	CMX90M	2.84	1.29					6 28309 19349 2
Zn	CMX90	10.84	4.92	in	4.33	5.67	3.54	6 28309 12827 2
Al	CMX95A	3.884	1.762	mm	110	144	95	6 28309 19342 3
Mg	CMX95M	2.557	1.160					6 28309 19350 8
Zn	CMX95Z	9.709	4.404	in	4.33	5.67	3.74	6 28309 23847 6
Al	CMX100AL	4.47	2.03	mm	100	150	100	6 28309 19243 3
Mg	CMX100M	2.92	1.32					6 28309 19244 0
Zn	CMX100	11.3	5.12	in	3.94	5.83	3.93	6 28309 12829 6
Al	CMX110A	11.15	5.06	mm	160	180	110	6 28309 23819 3
Mg	CMX110M	7.14	3.24					6 28309 23820 9
Zn	CMX110Z	28.79	13.06	in	6.30	7.09	4.33	6 28309 12831 9
Al	CMX115A	10.67	4.84	mm	160	180	115	6 28309 23822 3
Mg	CMX115M	6.83	3.10					6 28309 23823 0
Zn	CMX115Z	27.47	12.46	in	6.30	7.09	4.53	6 28309 12832 6
Al	CMX120A	9.356	4.244	mm	160	180	120	6 28309 23825 4
Mg	CMX120M	6.005	2.724					6 28309 23826 1
Zn	CMX120Z	24.048	10.908	in	6.30	7.09	4.72	6 28309 23827 8
Al	CMX123A	8.871	4.024	mm	160	180	123	6 28309 23828 5
Mg	CMX123M	5.718	2.594					6 28309 23829 2
Zn	CMX123Z	22.804	10.344	in	6.30	7.09	4.84	6 28309 23830 8
Al	CMX125A	8.430	3.824	mm	160	180	125	6 28309 23831 5
Mg	CMX125M	5.474	2.483					6 28309 23832 2
Zn	CMX125Z	21.832	9.903	in	6.30	7.09	4.92	6 28309 23833 9

**NEW
PRODUCT**

HEAVY DUTY STREAMLINED SHAFT ANODES / metric

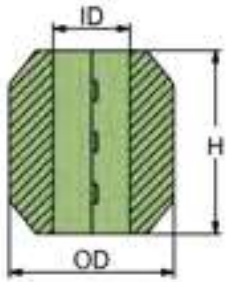

The world's best shaft anode design:

- Easy installation underwater: bolt retaining washers prevent the anode from falling off
- Interlocking halves
- Fit & longevity

	PID	LB	KG		H	OD	ID	UPC
Al	CMX09HDA	3.99	1.81	mm	120	106	51	6 28309 26582 3
Mg	CMX09HDM	2.58	1.17					6 28309 26593 9
Zn	CMX09HDZ	10.14	4.60	in	4.72	4.17	2.01	6 28309 26571 7
Al	CMX10HDA	3.75	1.70	mm	120	107.5	57	6 28309 26583 0
Mg	CMX10HDM	2.42	1.10					6 28309 26594 6
Zn	CMX10HDZ	9.48	4.30	in	4.72	4.23	2.2	6 28309 26572 4
Al	CMX11HDA	3.42	1.55	mm	120	107.5	64	6 28309 26584 7
Mg	CMX11HDM	2.22	1.01					6 28309 26595 3
Zn	CMX11HDZ	8.64	3.92	in	4.72	4.23	2.52	6 28309 26573 1
Al	CMX12HDA	4.83	2.19	mm	130	122.8	70	6 28309 26585 4
Mg	CMX12HDM	3.11	1.41					6 28309 26596 0
Zn	CMX12HDZ	12.34	5.6	in	5.12	4.83	2.75	6 28309 26574 8
Al	CMX13HDA	4.32	1.96	mm	130	122.8	76	6 28309 26586 1
Mg	CMX13HDM	2.80	1.27					6 28309 26597 7
Zn	CMX13HDZ	11.04	5.01	in	5.12	4.83	2.99	6 28309 26575 5
Al	CMX16HDA	15.83	7.18	mm	188	174.3	95	6 28309 26588 2
Mg	CMX16HDM	10.12	4.59					6 28309 26599 4
Zn	CMX16HDZ	40.86	18.53	in	7.40	6.86	3.75	6 28309 26576 6
Al	CMX17HDA	14.75	6.69	mm	188	174.3	102	6 28309 26589 8
Mg	CMX17HDM	9.44	4.28					6 28309 26601 1
Zn	CMX17HDZ	38.04	17.25	in	7.40	6.86	4	6 28309 26579 3
Al	CMX17LHDA	13.58	6.16	mm	188	174.3	108	6 28309 26591 5
Mg	CMX17LHDM	8.71	3.95					6 28309 26602 8
Zn	CMX17LHDZ	35.04	15.89	in	7.40	6.86	4.25	6 28309 26580 8
Al	CMX18HDA	12.37	5.61	mm	188	174.3	114	6 28309 26592 2
Mg	CMX18HDM	7.94	3.6					6 28309 26603 5
Zn	CMX18HDZ	31.84	14.44	in	7.40	6.86	4.5	6 28309 26581 5

CLAMP SHAFT ANODES / imperial

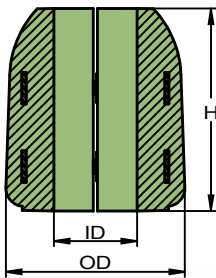

	PID	LB	KG		H	OD	ID	UPC
Al	CMXC01A	0.677	0.307	mm	65	56	19	6 28309 18009 6
Mg	CMXC01M	0.456	0.207					6 28309 24398 2
Zn	CMXC01Z	1.647	0.747	in	2.54	2.19	0.75	6 28309 17485 9
Al	CMXC02A	0.646	0.293	mm	65	56	22	6 28309 18010 2
Mg	CMXC02M	0.434	0.197					6 28309 24399 9
Zn	CMXC02Z	1.567	0.711	in	2.54	2.19	0.87	6 28309 17488 0
Al	CMXC03A	0.606	0.275	mm	65	56	25	6 28309 18011 9
Mg	CMXC03M	0.408	0.185					6 28309 19600 4
Zn	CMXC03Z	1.461	0.663	in	2.54	2.19	1	6 28309 17491 0
Al	CMXC04A	0.553	0.251	mm	65	56	29	6 28309 18012 6
Mg	CMXC04M	0.377	0.171					6 28309 24400 2
Zn	CMXC04Z	1.325	0.601	in	2.54	2.19	1.12	6 28309 17494 1
Al	CMXC05A	1.113	0.505	mm	78	70	32	6 28309 18013 3
Mg	CMXC05M	0.765	0.347					6 28309 24401 9
Zn	CMXC05Z	2.634	1.195	in	3.05	2.7	1.25	6 28309 17497 2

SHAFT & RUDDER ANODES

Choose
Aluminum

Al premium
SALT AND BRACKISH WATER

Anodes for
salt and brackish
water and
Magnesium

Mg fresh
FRESH WATER ONLY
for freshwater.

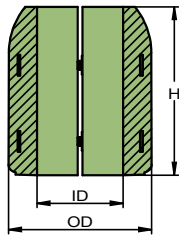

Comes with slotted head
w/lock washer & bolt
retaining washer.



Internal steel clamp insert holds
the anode completely tight
to the shaft



**Engineered to ensure
complete shaft contact:**

- Clamp insert ensures tight fit to shaft for duration of life
- Stainless steel hardware and lock washers included
- Bolt retaining washers prevent the anode from falling off – easy installation underwater

CLAMP SHAFT ANODES / imperial

	PID	LB	KG		H	OD	ID	UPC
Al	CMXC06A	1.038	0.471	mm	78	68.5	35	6 28309 18014 0
Mg	CMXC06M	0.716	0.325					6 28309 24402 6
Zn	CMXC06Z	2.440	1.107	in	3.05	2.697	1.37	6 28309 17500 9
Al	CMXC07A	1.003	0.455	mm	78	68.5	38	6 28309 18015 7
Mg	CMXC07M	0.694	0.315					6 28309 24403 3
Zn	CMXC07Z	2.352	1.067	in	3.05	2.697	1.5	6 28309 17503 0
Al	CMXC08A	2.21	1	mm	100	85	45	6 28309 18016 4
Mg	CMXC08M	1.47	0.66					6 28309 24404 0
Zn	CMXC08Z	5.48	2.49	in	3.92	3.33	1.75	6 28309 17506 1
Al	CMXC09A	1.87	0.85	mm	100	85	51	6 28309 18017 1
Mg	CMXC09M	1.25	0.57					6 28309 24405 7
Zn	CMXC09Z	4.57	2.07	in	3.92	3.33	2	6 28309 17509 2

CLAMP SHAFT ANODES / metric

	PID	LB	KG		H	OD	ID	UPC
Al	CMXC25A	0.606	0.275	mm	65	56	25	6 28309 18018 8
Mg	CMXC25M	0.412	0.187					6 28309 24406 4
Zn	CMXC25Z	1.461	0.663	in	2.5	2.2	1	6 28309 17512 2
Al	CMXC30A	0.529	0.240	mm	65	56	30	6 28309 18019 5
Mg	CMXC30M	0.357	0.162					6 28309 24407 1
Zn	CMXC30Z	1.269	0.576	in	2.5	2.2	1.19	6 28309 17515 3
Al	CMXC35A	1.03	0.47	mm	78	69	35	6 28309 18020 1
Mg	CMXC35M	0.70	0.32					6 28309 24408 8
Zn	CMXC35Z	2.42	1.10	in	3	2.74	1.37	6 28309 17518 4
Al	CMXC40A	0.950	0.431	mm	78	69	40	6 28309 18021 8
Mg	CMXC40M	0.663	0.301					6 28309 24409 5
Zn	CMXC40Z	2.215	1.005	in	3	2.74	1.58	6 28309 17521 4
Al	CMXC45A	2.18	0.99	mm	100	85	45	6 28309 18022 5
Mg	CMXC45M	1.38	0.62					6 28309 24410 1
Zn	CMXC45Z	5.42	2.46	in	4	3.33	1.75	6 28309 17524 5
Al	CMXC50A	1.986	0.901	mm	100	85	50	6 28309 18023 2
Mg	CMXC50M	1.325	0.601					6 28309 24411 8
Zn	CMXC50Z	4.883	2.215	in	4	3.33	2	6 28309 17527 6
Al	CMXC60A	1.492	0.677	mm	100	85	60	6 28309 18024 9
Mg	CMXC60M	1.016	0.461					6 28309 24412 5
Zn	CMXC60Z	3.604	1.635	in	4	3.33	2.33	6 28309 17530 6
Al	CMXC70A	2.64	1.19	mm	96	113	70	6 28309 18025 6
Mg	CMXC70M	1.61	0.73					6 28309 24413 2
Zn	CMXC70Z	6.54	2.96	in	3.75	4.43	2.75	6 28309 17533 7

LIMITED CLEARANCE SHAFT ANODES / imperial

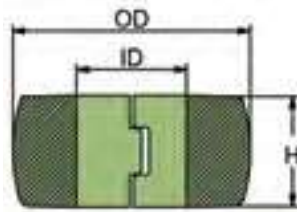

Easy installation underwater:

Bolt retaining washers prevent the anode from falling off. Choose from two of our stainless steel hardware options:



Allen head w/ lock washer & bolt retaining washer

Slotted head w/ lock washer & bolt retaining washer (add S to the PID)

- Full shaft contact: 100% circular radius
- Interlocking halves
- Extra alloy around fastener



	PID	LB	KG		H	OD	ID	UPC
Al	CMC01AL	0.319	0.145	mm	25.4	59.94	19.05	6 28309 19154 2
Mg	CMC01M	0.211	0.096					6 28309 24302 9
Zn	CMC01	0.793	0.36	in	1	2.36	0.75	6 28309 10303 3
Al	CMC02AL	0.302	0.137	mm	25.4	59.94	22.22	6 28309 19155 9
Mg	CMC02M	0.2	0.091					6 28309 24303 6
Zn	CMC02	0.749	0.34	in	1	2.36	0.875	6 28309 10304 0
Al	CMC03AL	0.525	0.238	mm	31.75	68.58	25.4	6 28309 17058 5
Mg	CMC03M	0.355	0.161					6 28309 15991 7
Zn	CMC03	1.272	0.577	in	1.25	2.7	1	6 28309 10305 7
Al	CMC04AL	0.509	0.231	mm	31.75	68.58	28.57	6 28309 19156 6
Mg	CMC04M	0.344	0.156					6 28309 24304 3
Zn	CMC04	1.232	0.559	in	1.25	2.7	1.125	6 28309 10306 4
Al	CMC05AL	0.475	0.215	mm	31.75	68.58	31.75	6 28309 17059 2
Mg	CMC05M	0.325	0.147					6 28309 15992 4
Zn	CMC05	1.14	0.517	in	1.25	2.7	1.25	6 28309 10307 1
Al	CMC06AL	0.699	0.317	mm	31.75	81.02	34.92	6 28309 17060 8
Mg	CMC06M	0.467	0.212					6 28309 15993 1
Zn	CMC06	1.713	0.777	in	1.25	3.19	1.375	6 28309 10308 8
Al	CMC07AL	0.694	0.315	mm	31.75	81.02	38.1	6 28309 19157 3
Mg	CMC07M	0.461	0.209					6 28309 22977 1
Zn	CMC07	1.713	0.777	in	1.25	3.19	1.5	6 28309 10309 5
Al	CMC08AL	1.036	0.470	mm	34.92	93.98	44.45	6 28309 19158 0
Mg	CMC08M	0.679	0.308					6 28309 24305 0
Zn	CMC08Z	2.606	1.182	in	1.375	3.7	1.75	6 28309 10310 1
Al	CMC09AL	0.875	0.397	mm	34.92	93.98	50.8	6 28309 10312 5
Mg	CMC09M	0.579	0.263					6 28309 24307 4
Zn	CMC09	2.176	0.987	in	1.375	3.7	2	6 28309 10311 8
Al	CMC09AAL	0.767	0.348	mm	34.92	93.98	57.15	6 28309 19160 3
Mg	CMC09AM	0.507	0.23					6 28309 24306 7
Zn	CMC09A	1.9	0.862	in	1.375	3.7	2.25	6 28309 19159 7
Al	CMC12AL	2.16	0.98	mm	38.1	132.08	63.5	6 28309 10314 9
Mg	CMC12M	1.402	0.636					6 28309 24311 1
Zn	CMC12	5.489	2.49	in	1.5	5.2	2.5	6 28309 10313 2
Al	CMC12AAL	2.015	0.914	mm	38.1	132.08	69.85	6 28309 19162 7
Mg	CMC12AM	1.289	0.585					6 28309 24310 4
Zn	CMC12A	5.084	2.306	in	1.5	5.2	2.75	6 28309 19161 0
Al	CMC13AL	1.852	0.84	mm	38.1	132.08	76.2	6 28309 19163 4
Mg	CMC13M	1.204	0.546					6 28309 24312 8
Zn	CMC13	4.691	2.128	in	1.5	5.2	3	6 28309 10315 6
Al	CMC14AL	3.393	1.539	mm	38.1	172.72	88.9	6 28309 19164 1
Mg	CMC14M	2.193	0.995					6 28309 24313 5
Zn	CMC14	8.659	3.928	in	1.5	6.8	3.5	6 28309 10316 3

SHAFT & RUDDER ANODES



LIMITED CLEARANCE SHAFT ANODES / imperial

	PID	LB	KG		H	OD	ID	UPC
Al	CMC15AL	2.98	1.354	mm	38.1	172.72	101.6	6 28309 19165 8
Mg	CMC15M	1.93	0.877					6 28309 24314 2
Zn	CMC15	7.59	3.445	in	1.5	6.8	4	6 28309 10317 0

LIMITED CLEARANCE SHAFT ANODES / metric

	PID	LB	KG		H	OD	ID	UPC
Al	CMC20AL	0.328	0.149	mm	25.4	60	20	6 28309 18987 7
Mg	CMC20M	0.216	0.098					6 28309 18997 6
Zn	CMC20	0.818	0.371	in	1	2.36	0.79	6 28309 11533 3
Al	CMC25AL	0.529	0.240	mm	31.75	68.7	25	6 28309 18989 1
Mg	CMC25M	0.357	0.162					6 28309 18999 0
Zn	CMC25	1.285	0.583	in	1.25	2.7	0.98	6 28309 11524 1
Al	CMC30AL	0.496	0.225	mm	31.75	68.7	30	6 28309 18988 4
Mg	CMC30M	0.337	0.153					6 28309 18998 3
Zn	CMC30	1.199	0.544	in	1.25	2.7	1.18	6 28309 11525 8
Al	CMC35AL	0.696	0.316	mm	31.75	81	35	6 28309 19166 5
Mg	CMC35M	0.465	0.211					6 28309 24315 9
Zn	CMC35	1.711	0.776	in	1.25	3.19	1.37	6 28309 11526 5
Al	CMC40AL	0.672	0.305	mm	31.75	81	40	6 28309 19167 2
Mg	CMC40M	0.447	0.203					6 28309 21038 0
Zn	CMC40	1.655	0.751	in	1.25	3.19	1.57	6 28309 11527 2
Al	CMC45A	0.985	0.447	mm	34.925	94	45	6 28309 24192 6
Mg	CMC45M	0.646	0.293					6 28309 24317 3
Zn	CMC45	2.475	1.123	in	1.375	3.7	1.77	6 28309 11528 9
Al	CMC50A	0.908	0.412	mm	34.925	94	50	6 28309 24193 3
Mg	CMC50M	0.597	0.271					6 28309 24319 7
Zn	CMC50	2.271	1.030	in	1.375	3.7	1.97	6 28309 11529 6
Al	CMC55A	1.23	0.56	mm	29	114	55	6 28309 23577 2
Mg	CMC55M	0.81	0.37					6 28309 23578 9
Zn	CMC55Z	3.12	1.42	in	1.14	4.49	2.17	6 28309 23579 6
Al	CMC60A	1.389	0.630	mm	27.5	123.5	60	6 28309 24194 0
Mg	CMC60M	0.924	0.419					6 28309 24320 3
Zn	CMC60	3.439	1.560	in	1.08	4.86	2.36	6 28309 12834 0
Al	CMC65A	1.547	0.702	mm	29	130	65	6 28309 23580 2
Mg	CMC65M	0.983	0.446					6 28309 23581 9
Zn	CMC65Z	3.805	1.726	in	1.14	5.118	2.56	6 28309 23582 6
Al	CMC70A	1.501	0.681	mm	27.5	132	70	6 28309 24197 1
Mg	CMC70M	0.994	0.451					6 28309 24323 4
Zn	CMC70	3.728	1.691	in	1.08	5.19	2.75	6 28309 12836 4
Al	CMC75A	1.662	0.754	mm	27.5	138	75	6 28309 24198 8
Mg	CMC75M	1.095	0.497					6 28309 24324 1
Zn	CMC75	4.149	1.882	in	1.08	5.43	2.95	6 28309 12837 1

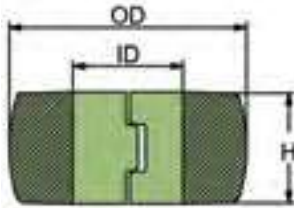

Martyr®
SHAFT & RUDDER ANODES

Easy installation underwater:

Bolt retaining washers prevent the anode from falling off. Choose from two of our stainless steel hardware options:



Allen head w/ lock washer & bolt retaining washer

Slotted head w/ lock washer & bolt retaining washer (add S to the PID)

LIMITED CLEARANCE SHAFT ANODES / metric

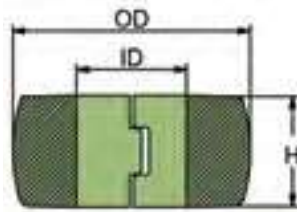

	PID	LB	KG		H	OD	ID	UPC
Al	CMC80A	1.666	0.756	mm	27.5	143	80	6 28309 24199 5
Mg	CMC80M	1.08	0.49					6 28309 24325 8
Zn	CMC80	4.16	1.887	in	1.08	5.63	3.15	6 28309 12838 8
Al	CMC85A	2.711	1.230	mm	35	160	85	6 28309 23583 3
Mg	CMC85M	1.763	0.800					6 28309 23584 0
Zn	CMC85Z	6.887	3.124	in	1.37	6.29	3.35	6 28309 23585 7
Al	CMC90A	3.554	1.612	mm	38	174	90	6 28309 24200 8
Mg	CMC90M	2.293	1.04					6 28309 24326 5
Zn	CMC90	9.074	4.116	in	1.49	6.85	3.54	6 28309 12840 1
Al	CMC95A	3.637	1.650	mm	38	174	95	6 28309 23586 4
Mg	CMC95M	2.319	1.052					6 28309 23587 1
Zn	CMC95Z	9.180	4.164	in	1.49	6.85	3.74	6 28309 23588 8
Al	CMC100A	3.889	1.764	mm	38	184	100	6 28309 24190 2
Mg	CMC100M	2.506	1.137					6 28309 24308 1
Zn	CMC100	9.951	4.514	in	1.49	7.24	3.94	6 28309 12842 5
Al	CMC120A	5.758	2.612	mm	37.5	223	120	6 28309 24191 9
Mg	CMC120M	3.69	1.674					6 28309 24309 8
Zn	CMC120	14.929	6.772	in	1.47	8.78	4.72	6 28309 12846 3

EURO STYLE LIMITED CLEARANCE SHAFT ANODES

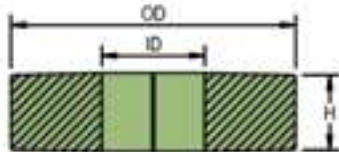

Thin euro style collar anodes.

Easy installation underwater. Bolt retaining washers prevent the anode from falling off.



Comes with allen head w/lock washer & bolt retaining washer

	PID	LB	KG		H	OD	ID	UPC
Al	CMC22EUROA	0.196	0.089	mm	15.5	60	22	6 28309 19459 8
Mg	CMC22EUROM	0.13	0.059					6 28309 21216 2
Zn	CMC22EURO	0.496	0.225	in	0.61	2.36	0.86	6 28309 16000 5
Al	CMC25EUROA	0.211	0.096	mm	15.5	60	25	6 28309 19460 4
Mg	CMC25EUROM	0.149	0.068					6 28309 21217 9
Zn	CMC25EURO	0.485	0.22	in	0.61	2.36	0.98	6 28309 16001 2
Al	CMC30EUROA	0.194	0.088	mm	15.5	60	30	6 28309 19461 1
Mg	CMC30EUROM	0.136	0.062					6 28309 21033 5
Zn	CMC30EURO	0.441	0.2	in	0.61	2.36	1.18	6 28309 16002 9
Al	CMC35EUROA	0.33	0.15	mm	17.6	74	35	6 28309 19462 8
Mg	CMC35EUROM	0.225	0.102					6 28309 21035 9
Zn	CMC35EURO	0.793	0.36	in	0.69	2.91	1.37	6 28309 16003 6
Al	CMC40EUROA	0.299	0.136	mm	17.6	74	40	6 28309 19463 5
Mg	CMC40EUROM	0.203	0.092					6 28309 21037 3
Zn	CMC40EURO	0.705	0.32	in	0.69	2.91	1.57	6 28309 16004 3
Al	CMC45EUROA	0.344	0.156	mm	18	82	45	6 28309 19464 2
Mg	CMC45EUROM	0.236	0.107					6 28309 24316 6
Zn	CMC45EURO	0.864	0.392	in	0.71	3.23	1.77	6 28309 16005 0
Al	CMC50EUROA	0.33	0.15	mm	18	82	50	6 28309 19465 9
Mg	CMC50EUROM	0.225	0.102					6 28309 24318 0
Zn	CMC50EURO	0.793	0.36	in	0.71	3.23	1.97	6 28309 16006 7

Choose
Aluminum

Al premium
SALT AND BRACKISH WATER

Anodes for
salt and brackish
water and
Magnesium

Mg fresh
FRESH WATER ONLY
for freshwater.

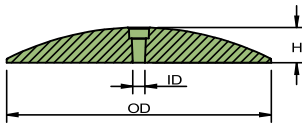

Martyr®
SHAFT & RUDDER ANODES

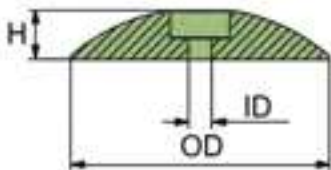

SOLD AS A SINGLE HALF

RUDDER/TRIM TAB ANODES

	PID	LB	KG		H	OD	ID	UPC
Al	CMR01AL	0.121	0.055	mm	6	47	5	6 28309 12783 1
Mg	CMR01M	0.081	0.037					6 28309 12787 9
Zn	CMR01	0.293	0.133	in	0.35	1.87	0.2	6 28309 10350 7
Al	CMR02AL	0.377	0.171	mm	12	71	7	6 28309 12784 8
Mg	CMR02M	0.249	0.113					6 28309 11536 4
Zn	CMR02	0.939	0.426	in	0.5	2.81	0.28	6 28309 10352 1
Al	CMR03AL	0.643	0.292	mm	12	95	9	6 28309 12785 5
Mg	CMR03M	0.425	0.193					6 28309 12788 6
Zn	CMR03	1.602	0.727	in	0.5	3.75	0.34	6 28309 10354 5
Al	CMR04AL	1.349	0.612	mm	16	127	9	6 28309 12786 2
Mg	CMR04M	0.875	0.397					6 28309 12791 6
Zn	CMR04	3.432	1.557	in	0.65	5	0.34	6 28309 10355 2
Al	CMR05AL	1.933	0.877	mm	22	130	9.5	6 28309 18272 4
Mg	CMR05M	1.250	0.567					6 28309 12792 3
Zn	CMR05	4.936	2.239	in	0.87	5.12	0.37	6 28309 10356 9
Al	CMR07AL	3.653	1.657	mm	23	175	8	6 28309 22976 4
Mg	CMR07M	2.484	1.127					6 28309 23317 4
Zn	CMR07	9.385	4.257	in	0.87	6.87	0.32	6 28309 10357 6

Rudder anodes are sold in pairs, with stainless steel bolt and nut.

- Easy installation underwater
- Bolt retaining washers prevent the anode from falling off

EURO STYLE RUDDER/TRIM TAB ANODES

	PID	LB	KG		H	OD	ID	UPC
Al	CMF50A	0.06	0.03	mm	11	50	7	6 28309 19263 1
Mg	CMF50M	0.04	0.02					6 28309 21190 5
Zn	CMF50Z	0.17	0.08	in	0.41	2	0.26	6 28309 17468 2
Al	CMF70A	0.156	0.071	mm	13	70	9	6 28309 19264 8
Mg	CMF70M	0.101	0.046					6 28309 21191 2
Zn	CMF70Z	0.399	0.181		0.5	2.75	0.35	6 28309 17470 5
Al	CMF90A	0.361	0.164	mm	17	90	9	6 28309 19265 5
Mg	CMF90M	0.231	0.105					6 28309 21192 9
Zn	CMF90Z	0.915	0.415	in	0.66	3.5	0.35	6 28309 17472 9
Al	CMF110A	0.568	0.258	mm	19	110	11	6 28309 19261 7
Mg	CMF110M	0.363	0.165					6 28309 21189 9
Zn	CMF110Z	1.439	0.653	in	0.75	4.33	0.42	6 28309 17462 0
Al	CMF125A	0.804	0.365	mm	21	125	11	6 28309 19262 4
Mg	CMF125M	0.509	0.231					6 28309 23234 4
Zn	CMF125Z	2.098	0.952	in	0.83	5	0.45	6 28309 17464 4

EURO STYLE RUDDER/TRIM TAB ANODES

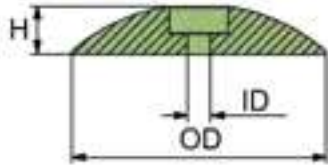

Rudder anodes are sold in pairs, with stainless steel bolt and nut.

- Easy installation underwater
- Bolt retaining washers prevent the anode from falling off



SOLD AS TWO HALVES, ASSEMBLED WITH A ZIP TIE

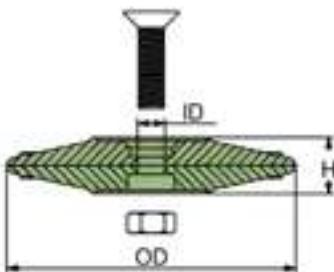
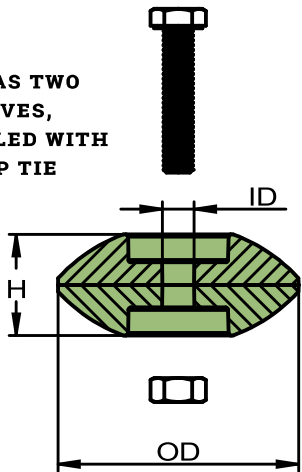

	PID	LB	KG		H	OD	ID	UPC
Al	CMF140A	1.300	0.590	mm	26	140	13	6 28309 21030 4
Mg	CMF140M	0.815	0.370					6 28309 23235 1
Zn	CMF140Z	3.395	1.540	in	1	5.5	0.5	6 28309 17466 8
Al	CMF190A	2.502	1.135	mm	29	190	11	6 28309 24206 0
Mg	CMF190M	1.587	0.720					6 28309 24332 6
Zn	CMF190Z	6.525	2.960	in	1.14	7.5	0.43	6 28309 24127 8

	PID	LB	KG		H	OD	ID	UPC
Al	CMF50CA	0.161	0.073	mm	22	50	7	6 28309 24672 3
Mg	CMF50CM	0.112	0.051					6 28309 24688 4
Zn	CMF50CZ	0.368	0.167	in	0.82	2	0.26	6 28309 24658 7
Al	CMF70CA	0.368	0.167	mm	26	70	9	6 28309 24673 0
Mg	CMF70CM	0.258	0.117					6 28309 24689 1
Zn	CMF70CZ	0.853	0.387	in	1.02	2 3/4	0.35	6 28309 24659 4
Al	CMF90CA	0.785	0.356	mm	34	90	9	6 28309 24674 7
Mg	CMF90CM	0.524	0.238					6 28309 24690 7
Zn	CMF90CZ	1.891	0.858	in	1.33	3 1/2	0.35	6 28309 24660 0
Al	CMF110CA	1.208	0.548	mm	38	110	11	6 28309 26004 0
Mg	CMF110CM	0.798	0.362					Please contact us
Zn	CMF110CZ	2.949	1.338	in	1.5	4 1/3	0.42	6 28309 24679 2
Al	CMF125CA	1.693	0.768	mm	42	125	11	6 28309 24666 2
Mg	CMF125CM	1.142	0.518					6 28309 24681 5
Zn	CMF125CZ	4.321	1.960	in	1.66	5	0.45	6 28309 24654 9
Al	CMF140CA	2.780	1.261	mm	52	140	13	6 28309 26005 7
Zn	CMF140CZ	6.969	3.161	in	2	5 1/2	0.5	6 28309 25981 5

SPANISH STYLE RUDDER/TRIM TAB ANODES

	PID	LB	KG		H	OD	ID	UPC
Al	CMF70SPA	0.211	0.096	mm	15	70	8.5	6 28309 23625 0
Mg	CMF70SPM	0.147	0.067					6 28309 23626 7
Zn	CMF70SPZ	0.494	0.224	in	0.59	2.75	0.33	6 28309 23627 4
Al	CMF90SPA	0.401	0.182	mm	17.4	90	8.5	6 28309 23628 1
Mg	CMF90SPM	0.267	0.121					6 28309 23629 8
Zn	CMF90SPZ	0.987	0.448	in	0.68	3.54	0.33	6 28309 23630 4
Al	CMF130SPA	0.941	0.427	mm	20	130	8.5	6 28309 23622 9
Mg	CMF130SPM	0.610	0.277					6 28309 23623 6
Zn	CMF130SPZ	2.40	1.088	in	0.78	5.12	0.33	6 28309 23624 3

SHAFT & RUDDER ANODES

PLEASURECRAFT

P R O P E L L E R

A N O D E S

PROPELLER NUT ANODES / incl. insert & hardware

PROP NUT COMPLETE

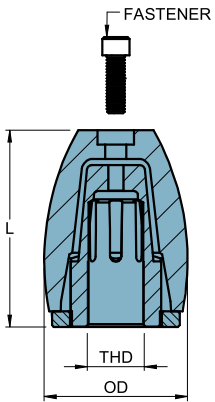

TYPE	PID	LB	KG		SHAFT	L	OD	THREAD	FASTER NER	UPC	
Al	A	CMPNAAC13	0.203	0.092	mm	19	38	32	1/2"-13 UNC	1/4- 20 x 1/2	6 28309 12078 8
Mg		CMPNAMC13	0.178	0.081							6 28309 11511 1
Zn		CMPNAZC13	0.339	0.154	in	0.75	1.5	1.25			6 28309 10824 3
Al	B	CMPNBAC11	0.434	0.197	mm	22	56	41	5/8"-11 UNC	1/4- 20 x 1/2	6 28309 12349 9
Mg		CMPNBMC11	0.370	0.168							6 28309 11342 1
Zn		CMPNBZC11	0.756	0.343	in	0.87	2.2	1.65			6 28309 10828 1
Al	C	CMPNCAC10	0.871	0.395	mm	25	74	48	3/4"-10 UNC	5/16- 18 x 1	6 28309 12211 9
Mg		CMPNCMC10	0.707	0.321							6 28309 11344 5
Zn		CMPNCZC10	1.558	0.707	in	1	2.9	2			6 28309 10831 1
Al	C	CMPNCAF16	0.871	0.395	mm	29	74	48	3/4"-16 UNF	5/16- 18 x 1	6 28309 12373 4
Mg		CMPNCMF16	0.707	0.321							6 28309 11345 2
Zn		CMPNCZF16	1.558	0.707	in	1.12	2.9	2			6 28309 10832 8
Al	D	CMPNDAC09	1.155	0.524	mm	32	78	54	7/8"-9 UNC	5/16- 18 x 1	6 28309 12212 6
Mg		CMPNDMC09	0.968	0.439							6 28309 11347 6
Zn		CMPNDZC09	2.178	0.988	in	1.25	3.06	2.3			6 28309 10835 9
Al	D	CMPNDAF14	1.159	0.526	mm	32	78	54	7/8"-14 UNF	5/16- 18 x 1	6 28309 12606 3
Mg		CMPNDMF14	0.937	0.425							6 28309 12033 7
Zn		CMPNDZF14	2.182	0.990	in	1.25	3.06	2.3			6 28309 10836 6
Al	E	CMPNEAC08	1.55	0.703	mm	35	86	60	1"-8 UNC	5/16- 18 x 1	6 28309 12213 3
Mg		CMPNEMC08	1.29	0.585							6 28309 11348 3
Zn		CMPNEZC08	2.63	1.193	in	1.37	3.4	2.5			6 28309 10838 0
Al	E	CMPNEAF14	1.54	0.698	mm	35	86	60	1"-14 UNF	5/16- 18 x 1	6 28309 12566 0
Mg		CMPNEMF14	1.28	0.580							6 28309 12054 2
Zn		CMPNEZF14	2.62	1.188	in	1.37	3.4	2.5			6 28309 11510 4
Al	F	CMPNFAC07	1.717	0.779	mm	38	89	70	1 1/8"-7 UNC	5/16- 18 x 1	6 28309 12214 0
Mg		CMPNFMC07	1.461	0.663							6 28309 11555 5
Zn		CMPNFZC07	3.002	1.362	in	1.5	3.5	2.75			6 28309 10839 7
Al	G	CMPNGAC07	2.59	1.18	mm	45	92	79.5	1 1/4"-7 UNC	3/8- 16 x 7/8	6 28309 12215 7
Mg		CMPNGMC07	2.25	1.02							6 28309 11556 2
Zn		CMPNGZC07	4.4	2	in	1.75	3.62	3.13			6 28309 10840 3
Al	H	CMPNHAC06	3.22	1.48	mm	51	102	83	1 1/2"-6 UNC	3/8- 16 x 7/8	6 28309 12395 6
Mg		CMPNHMC06	2.81	1.28							6 28309 11557 9
Zn		CMPNHZC06	5.25	2.39	in	2	4	3.34			6 28309 10841 0

PROPELLER ANODES

Choose
Aluminum

Al premium
SALT AND BRACKISH WATER

Anodes for
salt and brackish
water and
Magnesium

Mg fresh
FRESH WATER ONLY
for freshwater.

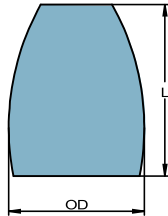

REPLACEMENT PROPELLER NUT ANODES

TYPE	PID	LB	KG		L	OD	UPC	
Al	A	CMPNAA	0.081	0.037	mm	38	32	6 28309 11813 6
Mg		CMPNMA	0.057	0.026				
Zn		CMPNZA	0.218	0.099	in	1.5	1.25	
Al	B	CMPNAB	0.192	0.087	mm	52	42	6 28309 11814 3
Mg		CMPNMB	0.128	0.058				
Zn		CMPNZB	0.513	0.233	in	2.05	1.65	
Al	C	CMPNAC	0.436	0.198	mm	67	51	6 28309 11815 0
Mg		CMPNMC	0.273	0.124				
Zn		CMPNZC	1.124	0.510	in	2.64	2	
Al	D	CMPNAD	1.389	0.630	mm	75	58	6 28309 11816 7
Mg		CMPNMD	0.904	0.410				
Zn		CMPNZD	3.637	1.650	in	2.95	2.3	
Al	E	CMPNAE	0.710	0.322	mm	79	64	6 28309 11817 4
Mg		CMPNME	0.450	0.204				
Zn		CMPNZE	1.790	0.812	in	3.13	2.5	
Al	F	CMPNAF	0.782	0.355	mm	84	70	6 28309 11361 2
Mg		CMPNMF	0.527	0.239				
Zn		CMPNZF	2.068	0.938	in	3.32	2.75	
Al	G	CMPNAG	1.109	0.503	mm	88	79	6 28309 11817 4
Mg		CMPNMG	0.747	0.339				
Zn		CMPNZG	2.934	1.331	in	3.46	3.13	
Al	H	CMPNAH	1.230	0.558	mm	98	85	6 28309 10877 9
Mg		CMPNMH	0.774	0.351				
Zn		CMPNZH	3.207	1.455	in	3.84	3.34	
								6 28309 12217 1
								6 28309 11364 3
								6 28309 10878 6

IMPORTANT PROP NUT FASTENERS:

- Fasteners are included with all replacement prop nuts.
- Nylon patch is good for one initial application only.
- Please use lock tite or teflon tape to ensure maximum hold.

Martyr
PROPELLER ANODES

AUTOPROP™ ANODES

	PID	LB	KG		H	OD	ID	D	ID1	UPC
Al	CMPNH5A	0.125	0.057	mm	33	57	28.6	40.7	6.9	6 28309 24242 8
Mg	CMPNH5M	0.079	0.036							
Zn	CMPNH5Z	0.330	0.150	in	1.3	2.24	1.13	1.6	0.27	
Al	CMPNH6A	0.308	0.140	mm	46	74	29.6	49.4	8.8	6 28309 17089 9
Mg	CMPNH6M	0.194	0.088							
Zn	CMPNH6Z	0.804	0.365	in	1.81	2.91	1.17	1.94	0.35	
										6 28309 24365 4
										6 28309 17090 5

	PID	LB	KG		OD	H	D	ID	ID1	UPC
Al	CMPNH9A	0.425	0.193	mm	89	46	62.18	40	11	6 28309 25524 4
Mg	CMPNH9M	0.269	0.122							
Zn	CMPNH9Z	1.106	0.502	in	3.50	1.81	2.45	1.57	0.43	
										6 28309 25519 0

AUTOPROP 3-BLADE PROPELLER H9

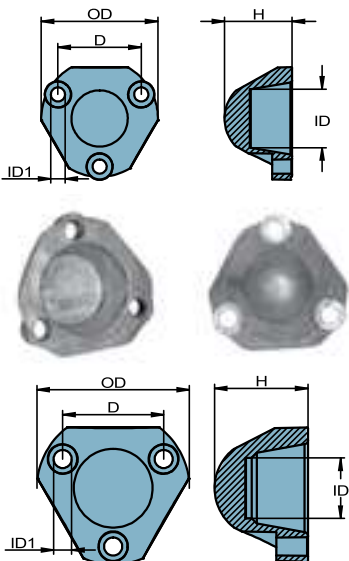

BENETEAU™ ANODES / incl. insert & hardware

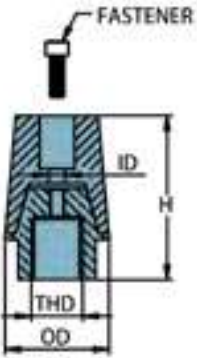
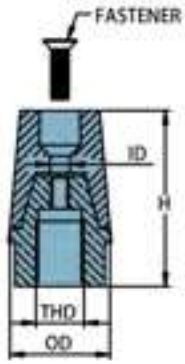

Prop Nut Complete		PID	LB	KG		OD	ID	H	THD	Fastener countersink socket head w/pitch	UPC
Al	22/25 mm	CMLAEC3250A	0.465	0.211	mm	34	6.9	59	M16 x 1.5	M6 x 20 SS	6 28309 24214 5
Mg		CMLAEC3250M	0.425	0.193	in	1.32	0.27	2.31			6 28309 24343 2
Zn		CMLAEC3250	0.646	0.293							6 28309 11315 5
Al	30mm	CMLAEC3300A	0.853	0.387	mm	42	8.1	77	M20 x 1.5	M8 x 30 SS	6 28309 24215 2
Mg		CMLAEC3300M	0.767	0.348	in	1.65	0.32	3.04			6 28309 24344 9
Zn		CMLAEC3300	1.228	0.557							6 28309 11316 2
Al	35mm	CMLAEC3500A	1.096	0.497	mm	46	8.1	83	M24 x 2	M8 x 30 SS	6 28309 24216 9
Mg		CMLAEC3500M	0.989	0.449	in	1.81	0.32	3.25			6 28309 24345 6
Zn		CMLAEC3500	1.565	0.710							6 28309 11317 9
Al	40mm	CMLAEC4000A	1.591	0.722	mm	51	8.1	95	M24 x 2	M8 x 30 SS	6 28309 24217 6
Mg		CMLAEC4000M	1.442	0.654	in	2.02	0.32	3.73			6 28309 24346 3
Zn		CMLAEC4000	2.293	1.040							6 28309 11318 6
Al	45mm	CMLAEC4500A	2.467	1.119	mm	61	10.4	108	M30 x 2	M10 x 30 SS	6 28309 24218 3
Mg		CMLAEC4500M	2.207	1.001	in	2.40	0.41	4.24			6 28309 24347 0
Zn		CMLAEC4500	3.576	1.622							6 28309 11319 3
Al	45mm	CMLAEC4500EUA	2.237	1.015	mm	59	10.5	103.3	M33 x 2	M10 x 25 SS	6 28309 21165 3
Mg		CMLAEC4500EUM	1.995	0.905	in	2.32	0.41	4.01			6 28309 21193 6
Zn		CMLAEC4500EUZ	3.185	1.445							6 28309 21143 1
Al	50mm	CMLAEC5000A	3.589	1.628	mm	71	12	117	M36 x 3	M10 x 30 SS	6 28309 19266 2
Mg		CMLAEC5000M	3.214	1.458	in	2.8	0.47	4.61			6 28309 19305 8
Zn		CMLAEC5000	5.330	2.418							6 28309 18203 8
Al	55mm	CMLAEC5500A	4.140	1.878	mm	72	11	118.5	M40 x 3	M10 x 30 SS	6 28309 19267 9
Mg		CMLAEC5500M	3.765	1.708	in	2.83	0.43	4.67			6 28309 19306 5
Zn		CMLAEC5500	5.573	2.528							6 28309 18204 5
Al	60mm	CMLAEC6000A	6.036	2.738	mm	81	11	136	M45 x 3	M10 x 30 SS	6 28309 19268 6
Mg		CMLAEC6000M	5.463	2.478	in	3.19	0.43	5.35			6 28309 19307 2
Zn		CMLAEC6000	8.263	3.748							6 28309 18205 2
Al	100mm	CMLAEC10000A	9.645	4.375	mm	99	11	144	M50 x 3	M10 x 30 SS	6 28309 23713 4
Mg		CMLAEC10000M	8.895	4.035	in	3.90	0.43	5.67			6 28309 23714 1
Zn		CMLAEC10000	12.934	5.867							6 28309 23712 7

PROPELLER ANODES

BENETEAU™ REPLACEMENT ANODES

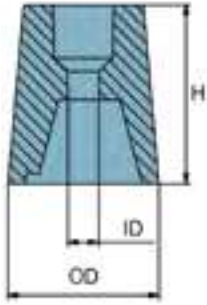

Prop Nut Replace		PID	LB	KG		H	OD	ID	UPC
Al	22/ 25mm	CMAN225A	0.111	0.050	mm	39	34	7	6 28309 19168 9
Mg		CMAN225M	0.071	0.032	in	1.55	1.32	0.27	6 28309 19324 9
Zn		CMAN225	0.290	0.131					6 28309 11308 7
Al	30mm	CMAN230A	0.230	0.104	mm	54	42	8	6 28309 19169 6
Mg		CMAN230M	0.146	0.066	in	2.11	1.65	0.32	6 28309 19325 6
Zn		CMAN230	0.600	0.272					6 28309 11309 4
Al	35mm	CMAN235A	0.289	0.131	mm	58	46	8	6 28309 19170 2
Mg		CMAN235M	0.183	0.083	in	2.28	1.81	0.32	6 28309 19326 3
Zn		CMAN235	0.758	0.344					6 28309 11310 0
Al	40mm	CMAN240A	0.419	0.190	mm	67	51	8	6 28309 19171 9
Mg		CMAN240M	0.269	0.122	in	2.62	2.02	0.32	6 28309 19327 0
Zn		CMAN240	1.119	0.508					6 28309 11311 7
Al	45mm	CMAN245A	0.690	0.313	mm	76	61	10	6 28309 19172 6
Mg		CMAN245M	0.430	0.195	in	2.99	2.4	0.40	6 28309 19328 7
Zn		CMAN245	1.800	0.816					6 28309 11312 4
Al	45mm	CMAN245EUA	0.66	0.30	mm	74	59	10.5	6 28309 21164 6
Mg		CMAN245EUM	0.42	0.19	in	2.9	2.3	0.41	6 28309 21188 2
Zn		CMAN245EUZ	1.61	0.73					6 28309 21140 0
Al	50mm	CMAN250A	1.014	0.460	mm	84	71	12	6 28309 19329 4
Mg		CMAN250M	0.639	0.290	in	3.3	2.8	0.5	6 28309 19330 0
Zn		CMAN250	1.909	0.866					6 28309 18004 1
Al	55mm	CMAN255A	0.99	0.45	mm	84	72	11	6 28309 19331 7
Mg		CMAN255M	0.62	0.28	in	3.3	2.8	0.4	6 28309 19332 4
Zn		CMAN255	2.47	1.12					6 28309 18005 8
Al	60mm	CMAN260A	1.57	0.71	mm	96	81	11	6 28309 19333 1
Mg		CMAN260M	0.99	0.45	in	3.8	3.2	0.4	6 28309 19334 8
Zn		CMAN260	3.88	1.76					6 28309 18006 5
Al	70mm	CMANCHN700A	1.345	0.610	mm	100	83	9	6 28309 12536 3
Mg		CMANCHN700M	0.857	0.389	in	3.94	3.27	0.35	6 28309 24298 5
Zn		CMANCHN700	3.527	1.600					6 28309 12535 6

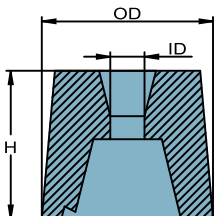
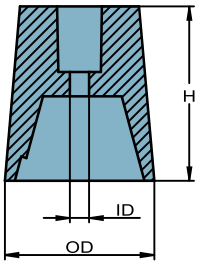

Martyr®
PROPELLER ANODES

FERRETTI™ ANODES



	PID	LB	KG		H	OD	ID	UPC
Al	CMFE1A	0.42	0.19	mm	65	50	10	6 28309 23634 2
Mg	CMFE1M	0.26	0.12					6 28309 23635 9
Zn	CMFE1Z	1.10	0.50	in	2.6	2	0.38	6 28309 23636 6

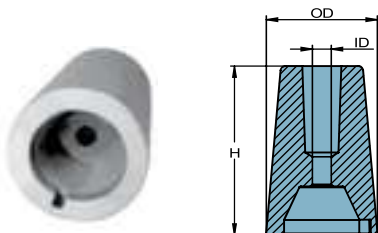

	PID	LB	KG		H	OD	ID	UPC
Al	CMFE2A	0.86	0.39	mm	90	59	10	6 28309 23637 3
Mg	CMFE2M	0.55	0.25					6 28309 23638 0
Zn	CMFE2Z	2.25	1.02	in	3.5	2.3	0.38	6 28309 23639 7

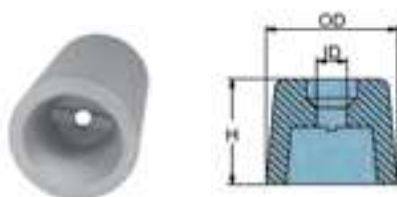

	PID	LB	KG		H	OD	ID	UPC
Al	CMFE3A	0.46	0.21	mm	65	50	7	6 28309 23640 3
Mg	CMFE3M	0.28	0.13					6 28309 23641 0
Zn	CMFE3Z	1.19	0.54	in	2.6	2	0.28	6 28309 23642 7

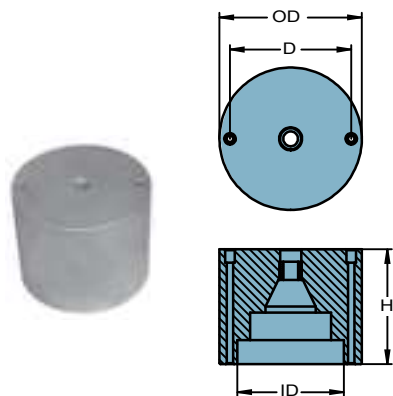

	PID	LB	KG		H	OD	D	iD	UPC
Al	CMFE80A	10.82	4.91	mm	125	155	132	116	6 28309 23649 6
Mg	CMFE80M	6.9	3.13						6 28309 23650 2
Zn	CMFE80Z	26.45	12	in	4.9	6.1	5.2	4.6	6 28309 23651 9



	PID	LB	KG		H	OD	ID	UPC
Al	CMFE4A	0.77	0.35	mm	75	60	10	6 28309 23643 4
Mg	CMFE4M	0.48	0.22					6 28309 23644 1
Zn	CMFE4Z	2.00	0.91	in	2.9	2.4	0.4	6 28309 23645 8

PROPELLER ANODES

Choose
Aluminum

Al premium
SALT AND BRACKISH WATER

Anodes for
salt and brackish
water and
Magnesium

Mg fresh
FRESH WATER ONLY

for freshwater.

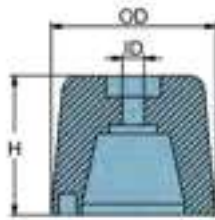

FERRETTI™ ANODES

	PID	LB	KG		H	OD	ID	UPC
Al	CMFE5A	1.54	0.70	mm	95	74	13.8	6 28309 23646 5
Mg	CMFE5M	0.99	0.45					6 28309 23647 2
Zn	CMFE5Z	4.05	1.84	in	3.7	2.9	0.54	6 28309 23648 9

FLEXOFOLD™ ANODES

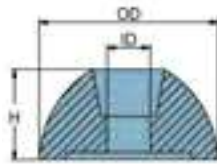
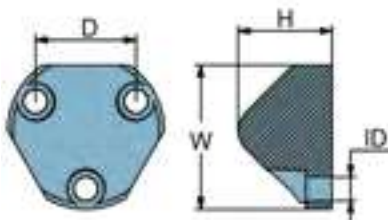

	PID	LB	KG		H	W	D	ID	UPC
Al	SGFF652A	0.264	0.120	mm	36	55	38.5	9	6 28309 18388 2
Mg	SGFF652M	0.169	0.077						6 28309 18389 9
Zn	SGFF652Z	0.690	0.313	in	1.42	2.16	1.51	0.35	6 28309 18288 5

	PID	LB	KG		OD	ID	H	UPC
Al	CMPNFXA	0.414	0.188	mm	67	8	38	6 28309 17572 6
Mg	CMPNFXM	0.260	0.118					6 28309 17621 1
Zn	CMPNFXZ	1.003	0.455	in	2.6	0.33	1.5	6 28309 17088 2

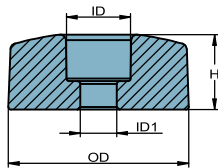

	PID	LB	KG		OD	H	ID	ID1	UPC
Al	CMPNFF2A	0.048	0.022	mm	31.7	13.3	11.25	6.4	6 28309 25185 7
Mg	CMPNFF2M	0.031	0.014						6 28309 25186 4
Zn	CMPNFF2Z	0.123	0.056	in	1.25	0.52	0.44	0.25	6 28309 25184 0

FLEX-O-FOLD 2-BLADE PROPELLER ANODE



	PID	LB	KG	Contains	UPC
Al	CMPNFF2KITA	0.260	0.118	CMPNFF2×2	6 28309 25188 8
Mg	CMPNFF2KITM	0.229	0.104		6 28309 25189 5
Zn	CMPNFF2KITZ	0.414	0.188		6 28309 25187 1

FLEX-O-FOLD 2-BLADE PROP ANODE KIT

Martyr®
PROPELLER ANODES

GORI™ ANODES

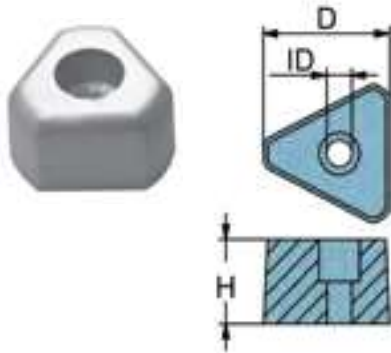

	PID	LB	KG		D	ID	H	UPC
Al	CM14072100A	0.028	0.013	mm	24	8	16	6 28309 23056 2
Mg	CM14072100M	0.019	0.009					6 28309 23072 2
Zn	CM14072100Z	0.077	0.035	in	0.9	0.33	0.6	6 28309 23038 8
Al	CM14073100A	0.042	0.019	mm	25	7	16	6 28309 23057 9
Mg	CM14073100M	0.028	0.013					6 28309 23073 9
Zn	CM14073100Z	0.094	0.043	in	1	0.26	0.6	6 28309 23039 5
Al	CM14074100A	0.079	0.036	mm	31	7	20	6 28309 23058 6
Mg	CM14074100M	0.053	0.024					6 28309 23074 6
Zn	CM14074100Z	0.194	0.088	in	1.2	0.26	0.8	6 28309 23040 1
Al	CM14074511A	0.231	0.105	mm	40	7	33	6 28309 23059 3
Mg	CM14074511M	0.154	0.070					6 28309 23075 3
Zn	CM14074511Z	0.573	0.260	in	1.6	0.26	1.3	6 28309 23041 8

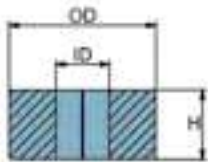

	PID	LB	KG		OD	ID	H	UPC
Al	CM15539500A	0.718	0.326	mm	95	60	34	6 28309 23063 0
Mg	CM15539500M	0.456	0.207					6 28309 23079 1
Zn	CM15539500Z	1.860	0.844	in	3.7	2.4	1.3	6 28309 23045 6
Al	CM15540000A	1.031	0.468	mm	95	63	47	6 28309 23064 7
Mg	CM15540000M	0.657	0.298					6 28309 23080 7
Zn	CM15540000Z	2.676	1.214	in	3.7	2.5	1.8	6 28309 23046 3
Al	CM15530000A	0.70	0.32	mm	83	53	40	6 28309 23062 3
Mg	CM15530000M	0.44	0.20					6 28309 23078 4
Zn	CM15530000Z	1.90	0.86	in	3.3	2.1	1.6	6 28309 23044 9
Al	CM15500000A	1.622	0.736	mm	127	90	50	6 28309 23060 9
Mg	CM15500000M	1.034	0.469					6 28309 23076 0
Zn	CM15500000Z	4.204	1.907	in	5	3.5	2	6 28309 23042 5
Al	CM15670000A	0.427	0.194	mm	97	80	40	6 28309 23065 4
Mg	CM15670000M	0.273	0.124					6 28309 23081 4
Zn	CM15670000Z	1.111	0.504	in	3.8	3.1	1.6	6 28309 23047 0
Al	CM15527500A	0.255	0.116	mm	80	55	23	6 28309 23061 6
Mg	CM15527500M	0.163	0.074					6 28309 23077 7
Zn	CM15527500Z	0.665	0.302	in	3.2	2.2	0.9	6 28309 23043 2

PROPELLER ANODES

J-PROP™ ANODES

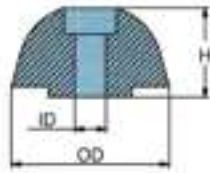

	PID	LB	KG		OD	ID	H	UPC
Al	CMJPROP60A	0.282	0.128	mm	60	9	25	6 28309 20969 8
Mg	CMJPROP60M	0.178	0.081					6 28309 20990 2
Zn	CMJPROP60Z	0.736	0.334	in	2.4	0.34	1	6 28309 20948 3
Al	CMJPROP80A	0.637	0.289	mm	80	10	33	6 28309 23676 2
Mg	CMJPROP80M	0.405	0.184					6 28309 23677 9
Zn	CMJPROP80Z	1.649	0.748	in	3.1	0.4	1.3	6 28309 23678 6
Al	CMJPROP90A	0.831	0.377	mm	90	10	37	6 28309 23679 3
Mg	CMJPROP90M	0.529	0.240					6 28309 23680 9
Zn	CMJPROP90Z	2.156	0.978	in	3.5	0.4	1.5	6 28309 23681 6

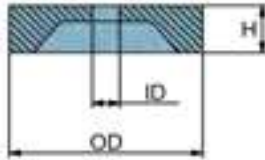

	PID	LB	KG		OD	ID	H	UPC
Al	CMJP60A	0.189	0.086	mm	60	9	15	6 28309 24213 8
Mg	CMJP60M	0.119	0.054					6 28309 24339 5
Zn	CMJP60Z	0.491	0.223	in	2.4	0.3	0.6	6 28309 24135 3

MAX PROP™ ANODES

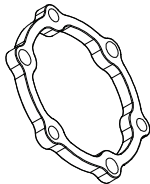
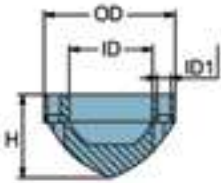

	PID	LB	KG		ID	ID1	OD	H	Fastener	UPC
Al	CMMP63RA	0.23	0.107	mm	39	5.3	62.4	39	M5 x 20	6 28309 17062 2
Mg	CMMP63RM	0.15	0.068							6 28309 17053 0
Zn	CMMP63RZ	0.61	0.278	in	1.53	0.21	2.45	1.53		6 28309 10738 3
Al	CMMP70RA	0.34	0.154	mm	43.8	4.8/5.3	68	43	M4 x 20	6 28309 17063 9
Mg	CMMP70RM	0.23	0.1							6 28309 17054 7
Zn	CMMP70RZ	0.86	0.389	in	1.72	0.19/ 0.21	2.68	1.69		6 28309 10739 0
Al	CMMP83RA	0.65	0.298	mm	47	5.3/ 6.4	82.4	57	M5 x 20	6 28309 17064 6
Mg	CMMP83RM	0.419	0.190							6 28309 17055 4
Zn	CMMP83RZ	1.666	0.756	in	1.85	0.21/ 0.25	3.24	2.24		6 28309 10740 6

COMES WITH INSERT
- NEW DESIGN -



Martyr®
PROPELLER ANODES

MAX PROP™ ANODES

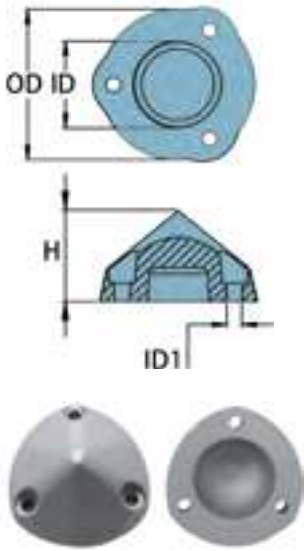

	PID	LB	KG		OD	H	ID	ID1	Fastener	UPC
Al	CMMP63MA	0.240	0.109	mm	62	39	38.3	6.3	M5 x 20SS	6 28309 23727 1
Mg	CMMP63MM	0.152	0.069							6 28309 23728 8
Zn	CMMP63MZ	0.624	0.283	in	2.44	1.54	1.51	0.25		6 28309 23729 5
Al	CMMP70MA	0.279	0.127	mm	70	41	42.4	6.3		6 28309 23733 2
Mg	CMMP70MM	0.178	0.081							6 28309 23734 9
Zn	CMMP70MZ	0.732	0.332	in	2.76	1.61	1.67	0.25		6 28309 23735 6
Al	CMMP83MA	0.685	0.311	mm	78	54	46.4	7.2	M6 x 25SS	6 28309 23739 4
Mg	CMMP83MM	0.434	0.197							6 28309 23740 0
Zn	CMMP83MZ	1.785	0.810	in	3.07	2.13	1.83	0.28		6 28309 23741 7
Al	CMMP100MA	0.778	0.353	mm	93	55	53.4	6.8		6 28309 23068 5
Mg	CMMP100MM	0.496	0.225							6 28309 23084 5
Zn	CMMP100MZ	2.019	0.916	in	3.66	2.17	2.10	0.27		6 28309 23052 4
Al	CMMP125MA	1.931	0.876	mm	127	79	82	10.8	--	6 28309 23718 9
Mg	CMMP125MM	1.225	0.556							6 28309 23719 6
Zn	CMMP125MZ	5.039	2.286	in	5.00	3.11	3.23	0.43		6 28309 23720 2

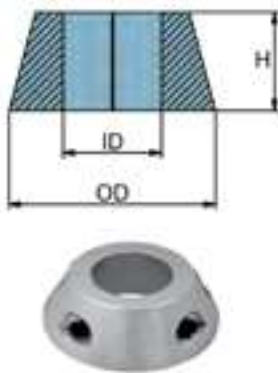

	PID	LB	KG		OD	ID	H	UPC
Al	CMMP70SDA	0.621	0.282	mm	93	42	28	6 28309 23736 3
Mg	CMMP70SDM	0.416	0.189					6 28309 23737 0
Zn	CMMP70SDZ	1.528	0.693	in	3.7	1.6	1.1	6 28309 23738 7
Al	CMMP83SDA	0.582	0.264	mm	93	46	28	6 28309 23742 4
Mg	CMMP83SDM	0.390	0.177					6 28309 23743 1
Zn	CMMP83SDZ	1.422	0.645	in	3.7	1.8	1.1	6 28309 23744 8

PROPELLER ANODES

Choose
Aluminum

Al premium
SALT AND BRACKISH WATER

Anodes for
salt and brackish
water and
Magnesium

Mg fresh
FRESH WATER ONLY

for freshwater.

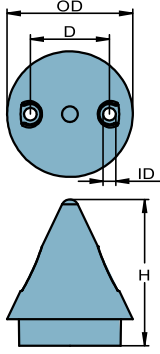

MAX PROP™ ANODES

	PID	LB	KG		OD	D	ID	H	UPC
Al	CMMP63M2BA	0.161	0.073	mm	44	27.55	4.4	51	6 28309 23724 0
Mg	CMMP63M2BM	0.101	0.046						6 28309 23725 7
Zn	CMMP63M2BZ	0.419	0.190	in	1.7	1.1	0.17	2	6 28309 23726 4



MTF™ ANODES

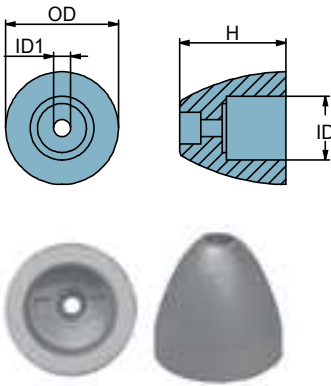

	PID	LB	KG		OD	ID	ID1	H	UPC
Al	CMMTF1A	0.101	0.046	mm	38	28	7	38	6 28309 23745 5
Mg	CMMTF1M	0.064	0.029						6 28309 23746 2
Zn	CMMTF1Z	0.264	0.120	in	1.5	1.10	0.27	1.5	6 28309 23747 9
Al	CMMTF2A	0.260	0.118	mm	53.5	35.5	7	50	6 28309 23748 6
Mg	CMMTF2M	0.165	0.075						6 28309 23749 3
Zn	CMMTF2Z	0.679	0.308	in	2.11	1.40	0.26	2	6 28309 23750 9
Al	CMMTF3A	0.602	0.273	mm	65.5	45	7	77	6 28309 23751 6
Mg	CMMTF3M	0.381	0.173						6 28309 23752 3
Zn	CMMTF3Z	1.567	0.711	in	2.6	1.8	0.28	3	6 28309 23753 0

Martyr
PROPELLER ANODES

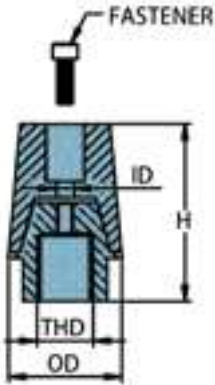

RADICE™ ANODES

	PID	LB	KG		OD	ID	H	THD	Fastener	UPC
Al	CMLAEC3250EUA	0.45	0.21	mm	33	7	59	M16 x 1.5	M6 x 16SS	6 28309 21488 3
Mg	CMLAEC3250EUM	0.41	0.19							6 28309 21489 0
Zn	CMLAEC3250EUZ	0.61	0.28	in	1.28	0.27	2.32			6 28309 21490 6
Al	CMLAEC3300EUA	0.87	0.40	mm	44	9	74	M20 x 1.5	M8 x 25SS	6 28309 21491 3
Mg	CMLAEC3300EUM	0.77	0.35							6 28309 21492 0
Zn	CMLAEC3300EUZ	1.31	0.59	in	1.73	0.35	2.91			6 28309 21493 7
Al	CMLAEC3500EUA	1.05	0.48	mm	44	9	77	M24 x 2	M8 x 25SS	6 28309 21494 4
Mg	CMLAEC3500EUM	0.96	0.44							6 28309 21495 1
Zn	CMLAEC3500EUZ	1.41	0.64	in	1.73	0.35	3.03			6 28309 21496 8
Al	CMLAEC4000EUA	1.54	0.70	mm	50	9	93	M24 x 2	M8 x 25SS	6 28309 21497 5
Mg	CMLAEC4000EUM	1.39	0.63							6 28309 21498 2
Zn	CMLAEC4000EUZ	2.17	0.99	in	1.97	0.35	3.66			6 28309 21499 9



RADICE™ ANODES



	PID	LB	KG		OD	ID	H	THD	Fastener	UPC
Al	CMLAEC4500EUA	2.237	1.015	mm	59	10.5	103.3	M33 x 2	M10 x 25SS	6 28309 21165 3
Mg	CMLAEC4500EUM	1.995	0.905							6 28309 21193 6
Zn	CMLAEC4500EUZ	3.185	1.445	in	2.32	0.41	4.07			6 28309 21143 1
Al	CMLAEC5000A	3.589	1.628	mm	71	12	117	M36 x 3	M10 x 30SS	6 28309 19266 2
Mg	CMLAEC5000M	3.214	1.458							6 28309 19305 8
Zn	CMLAEC5000	5.330	2.418	in	2.80	0.47	4.61			6 28309 18203 8
Al	CMLAEC5500A	4.140	1.878	mm	72	11	118.5	M40 X3	M10 x 30SS	6 28309 19267 9
Mg	CMLAEC5500M	3.765	1.708							6 28309 19306 5
Zn	CMLAEC5500	5.573	2.528	in	2.80	0.43	4.67			6 28309 18204 5
Al	CMLAEC6000A	6.036	2.738	mm	81	11	136	M45 X3	M10 x 30SS	6 28309 19268 6
Mg	CMLAEC6000M	5.463	2.478							6 28309 19307 2
Zn	CMLAEC6000	8.263	3.748	in	3.19	0.43	5.35			6 28309 18205 2
Al	CMLAEC10000A	9.645	4.375	mm	99	11	144	M50 X3	M10 x 30SS	6 28309 23713 4
Mg	CMLAEC10000M	8.895	4.035							6 28309 23714 1
Zn	CMLAEC10000	12.934	5.867	in	3.90	0.43	5.67			6 28309 23712 7

RADICE™ REPLACEMENT ANODES

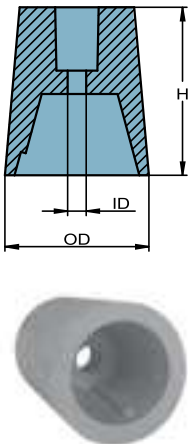

	PID	LB	KG		OD	ID	H	UPC
Al	CMAN225EUA	0.108	0.049	mm	33	7	39	6 28309 20965 0
Mg	CMAN225EUM	0.068	0.031					6 28309 20986 5
Zn	CMAN225EUZ	0.264	0.120	in	1.28	0.27	1.54	6 28309 20944 5
Al	CMAN230EUA	0.282	0.128	mm	44	9	52	6 28309 20966 7
Mg	CMAN230EUM	0.178	0.081					6 28309 20987 2
Zn	CMAN230EUZ	0.716	0.325	in	1.73	0.35	2.05	6 28309 20945 2
Al	CMAN235EUA	0.242	0.110	mm	44	9	52	6 28309 20967 4
Mg	CMAN235EUM	0.154	0.070					6 28309 20988 9
Zn	CMAN235EUZ	0.610	0.277	in	1.73	0.35	2.05	6 28309 20946 9

RADICE™ REPLACEMENT ANODES

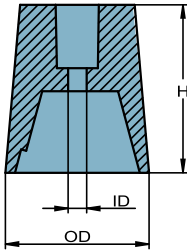

PID		LB	KG		OD	ID	H	UPC
Al	CMAN240EUA	0.410	0.186	mm	50	9	65	6 28309 20968 1
Mg	CMAN240EUM	0.260	0.118	in	1.97	0.35	2.56	6 28309 20989 6
Zn	CMAN240EUZ	1.036	0.470					6 28309 20947 6
Al	CMAN245EUA	0.66	0.30	mm	59	10.5	74	6 28309 21164 6
Mg	CMAN245EUM	0.42	0.19	in	2.32	0.41	2.91	6 28309 21188 2
Zn	CMAN245EUZ	1.61	0.73					6 28309 21140 0
Al	CMAN250A	1.014	0.460	mm	71	12	84	6 28309 19329 4
Mg	CMAN250M	0.639	0.290	in	2.8	0.5	3.3	6 28309 19330 0
Zn	CMAN250	2.755	1.250					6 28309 18004 1
Al	CMAN255A	0.99	0.45	mm	72	11	84	6 28309 19331 7
Mg	CMAN255M	0.62	0.28	in	2.8	0.4	3.3	6 28309 19332 4
Zn	CMAN255	2.47	1.12					6 28309 18005 8
Al	CMAN260A	1.57	0.71	mm	81	11	96	6 28309 19333 1
Mg	CMAN260M	0.99	0.45	in	3.2	0.4	3.8	6 28309 19334 8
Zn	CMAN260	3.88	1.76					6 28309 18006 5
Al	CMAN2100A	2.07	0.94	mm	99	11	100	6 28309 23066 1
Mg	CMAN2100M	1.32	0.60	in	3.90	0.43	3.94	6 28309 23082 1
Zn	CMAN2100Z	5.36	2.43					6 28309 23050 0

RADICE™ REPLACEMENT WASHERS

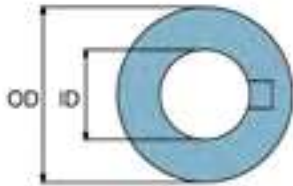

PID	LB	KG		OD	ID	Shaft	UPC
WASHRAD2225C	0.015	0.007	mm	38	17	25	6 28309 20914 8
			in	1.50	0.67		
WASHRAD30C	0.022	0.010	mm	46	21	30	6 28309 20915 5
			in	1.81	0.82		
WASHRAD35C	0.026	0.012	mm	51	25	35	6 28309 20916 2
			in	2.00	0.98		
WASHRAD40C	0.031	0.014	mm	54	25	40	6 28309 20917 9
			in	2.12	0.98		
WASHRAD45C	0.042	0.019	mm	66	34	45	6 28309 20918 6
			in	2.60	1.34		
WASHRAD50C	0.059	0.027	mm	76	37	50	6 28309 20919 3
			in	3.00	1.45		
WASHRAD55C	0.066	0.030	mm	81	41	55	6 28309 20920 9
			in	3.20	1.61		
WASHRAD60C	0.079	0.036	mm	90	46	60	6 28309 20921 6
			in	3.54	1.81		
WASHRAD100C	0.110	0.050	mm	104	52	100	6 28309 24698 3
			in	4.09	2.05		

Martyr®
PROPELLER ANODES

RADICE™ ANODES / hexagonal

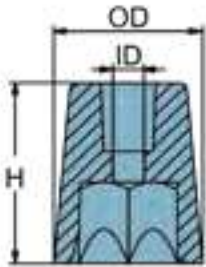

	PID	LB	KG		OD	ID	H	THD	Fastener	UPC
Al	CMPNRAD225CA	0.498	0.226	mm	33	7	40	M16 x 1.5	M6 X 20	6 28309 23296 2
Mg	CMPNRAD225CM	0.465	0.211							6 28309 24366 1
Zn	CMPNRAD225C	0.643	0.292	in	1.3	0.26	1.6			6 28309 16018 0
Al	CMPNRAD30CA	0.859	0.390	mm	42	9	53	M20 x 1.5	M8 X 20	6 28309 23297 9
Mg	CMPNRAD30CM	0.782	0.355							6 28309 24367 8
Zn	CMPNRAD30C	1.219	0.553	in	1.6	0.34	2.1			6 28309 16020 3
Al	CMPNRAD35CA	1.195	0.542	mm	46	9	62	M24 x 2	M8 X 25	6 28309 23298 6
Mg	CMPNRAD35CM	1.087	0.493							6 28309 24368 5
Zn	CMPNRAD35C	1.691	0.767	in	1.8	0.34	2.4			6 28309 16022 7
Al	CMPNRAD40CA	1.713	0.777	mm	52	9	67	M24 X 2	M8 X 20	6 28309 23299 3
Mg	CMPNRAD40CM	1.569	0.712							6 28309 24369 2
Zn	CMPNRAD40C	2.334	1.059	in	2	0.34	2.6			6 28309 16024 1
Al	CMPNRAD45C	2.412	1.094	mm	61	11	76	M33 x 2	M10 X 25	6 28309 23300 6
Mg	CMPNRAD45CM	2.180	0.989							6 28309 24370 8
Zn	CMPNRAD45C	3.426	1.554	in	2.4	0.43	3			6 28309 16026 5
Al	CMPNRAD50CA	3.796	1.722	mm	72	11	83	M36 x 3	M10 x 35	6 28309 23301 3
Mg	CMPNRAD50CM	3.512	1.593							6 28309 24371 5
Zn	CMPNRAD50C	5.042	2.287	in	2.8	0.43	3.3			6 28309 16028 9
Al	CMPNRAD55CA	4.316	1.958	mm	75	11	87	M40 x 3	M10 x 35	6 28309 24244 2
Mg	CMPNRAD55CM	4.036	1.831							6 28309 24372 2
Zn	CMPNRAD55C	5.533	2.510	in	2.9	0.43	3.4			6 28309 16030 2
Al	CMPNRAD60CA	5.890	2.672	mm	83	11	98	M45 x 3	M10 x 35	6 28309 24245 9
Mg	CMPNRAD60CM	5.366	2.434							6 28309 24373 9
Zn	CMPNRAD60C	8.192	3.716	in	3.3	0.43	3.8			6 28309 16032 6
Al	CMPNRAD100AC	8.98	4.08	mm	97	11	96	M50 x 3	M10 x 35	6 28309 23775 2
Mg	CMPNRAD100MC	8.18	3.72							6 28309 23777 6
Zn	CMPNRAD100ZC	12.47	5.67	in	3.82	0.42	3.78			6 28309 23779 0

PROPELLER ANODES

Choose
Aluminum

Al premium
SALT AND BRACKISH WATER

Anodes for
salt and brackish
water and
Magnesium

Mg fresh
FRESH WATER ONLY

for freshwater.

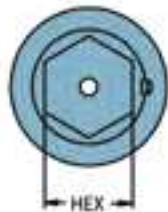
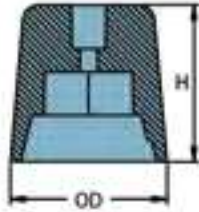

Martyr
PROPELLER ANODES

RADICE™ REPLACEMENT ANODES / hexagonal

	PID	LB	KG		OD	HEX	H	UPC
Al	CMPNRAD225A	0.092	0.042	mm	33	22	40	6 28309 19269 3
Mg	CMPNRAD225M	0.059	0.027					6 28309 19308 9
Zn	CMPNRAD225	0.242	0.110	in	1.30	0.87	1.57	6 28309 16017 3
Al	CMPNRAD30A	0.214	0.097	mm	42	27	53	6 28309 19270 9
Mg	CMPNRAD30M	0.136	0.062					6 28309 19309 6
Zn	CMPNRAD30	0.551	0.250	in	1.65	1.06	2.09	6 28309 16019 7
Al	CMPNRAD35A	0.297	0.135	mm	46	32	62	6 28309 19271 6
Mg	CMPNRAD35M	0.189	0.086					6 28309 19310 2
Zn	CMPNRAD35	0.771	0.350	in	1.81	1.26	2.44	6 28309 16021 0
Al	CMPNRAD40A	0.392	0.178	mm	52	36	67	6 28309 19272 3
Mg	CMPNRAD40M	0.249	0.113					6 28309 19311 9
Zn	CMPNRAD40	1.014	0.460	in	2.05	1.42	2.64	6 28309 16023 4
Al	CMPNRAD45A	0.639	0.290	mm	61	41	76	6 28309 19273 0
Mg	CMPNRAD45M	0.408	0.185					6 28309 19312 6
Zn	CMPNRAD45	1.653	0.750	in	2.40	1.61	2.99	6 28309 16025 8
Al	CMPNRAD50A	0.782	0.355	mm	72	46	83	6 28309 19274 7
Mg	CMPNRAD50M	0.498	0.226					6 28309 19313 3
Zn	CMPNRAD50	2.028	0.920	in	2.83	1.81	3.23	6 28309 16027 2
Al	CMPNRAD55A	0.767	0.348	mm	75	50	87	6 28309 19275 4
Mg	CMPNRAD55M	0.487	0.221					6 28309 16029 6
Zn	CMPNRAD55	1.984	0.900	in	2.95	1.97	3.43	6 28309 19314 0
Al	CMPNRAD60A	1.446	0.656	mm	83	55	98	6 28309 19276 1
Mg	CMPNRAD60M	0.921	0.418					6 28309 19315 7
Zn	CMPNRAD60	3.748	1.700	in	3.23	2.17	3.86	6 28309 16031 9
Al	CMPNRAD100A	2.109	0.957	mm	97	54	96	6 28309 23774 5
Mg	CMPNRAD100M	1.338	0.607					6 28309 23776 9
Zn	CMPNRAD100Z	5.498	2.494	in	3.82	2.13	3.78	6 28309 23778 3

REGGIANI™ ANODES

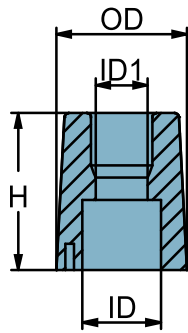

	PID	LB	KG		OD	ID	ID1	H	Shaft	UPC
Al	CMRG20A	0.072	0.033	mm	28	15	7	30	20	6 28309 23786 8
Mg	CMRG20M	0.046	0.021							6 28309 23787 5
Zn	CMRG20Z	0.189	0.086	in	1.1	0.6	0.28	1.2		6 28309 23788 2
Al	CMRG25A	0.108	0.049	mm	34	20	7	34	25	6 28309 23069 2
Mg	CMRG25M	0.068	0.031							6 28309 23085 2
Zn	CMRG25Z	0.279	0.127	in	1.3	0.8	0.28	1.3		6 28309 23053 1
Al	CMRG30A	0.279	0.127	mm	44	25	7	50	30	6 28309 23070 8
Mg	CMRG30M	0.178	0.081							6 28309 23086 9
Zn	CMRG30Z	0.725	0.329	in	1.7	1	0.27	2		6 28309 23054 8
Al	CMRG35A	0.344	0.156	mm	48	28	9	55	35	6 28309 23071 5
Mg	CMRG35M	0.218	0.099							6 28309 23087 6
Zn	CMRG35Z	0.917	0.416	in	1.9	1.1	0.34	2.2		6 28309 23055 5
Al	CMRG40A	0.416	0.189	mm	54	34	11	55	40	6 28309 23789 9
Mg	CMRG40M	0.264	0.120							6 28309 23790 5
Zn	CMRG40Z	1.080	0.490	in	2.1	1.3	0.41	2.2		6 28309 23791 2
Al	CMRG45A	0.736	0.334	mm	64	40	12	63	45	6 28309 23792 9
Mg	CMRG45M	0.469	0.213							6 28309 23793 6
Zn	CMRG45Z	1.909	0.866	in	2.5	1.6	0.47	2.5		6 28309 23794 3
Al	CMRG50A	1.206	0.547	mm	74	45	11	75	50	6 28309 23795 0
Mg	CMRG50M	0.767	0.348							6 28309 23796 7
Zn	CMRG50Z	3.126	1.418	in	2.9	1.8	0.44	3		6 28309 23797 4
Al	CMRG55A	1.345	0.610	mm	78	49	10.5	75	55	6 28309 23798 1
Mg	CMRG55M	0.882	0.400							6 28309 23799 8
Zn	CMRG55Z	3.386	1.536	in	3.1	1.9	0.41	3		6 28309 23800 1
Al	CMRG60A	2.052	0.931	mm	88	55	10.5	85	60	6 28309 23801 8
Mg	CMRG60M	1.367	0.620							6 28309 23802 5
Zn	CMRG60Z	5.062	2.296	in	3.5	2.2	0.41	3.3		6 28309 23803 2

PROPELLER ANODES

RIVA™ ANODES

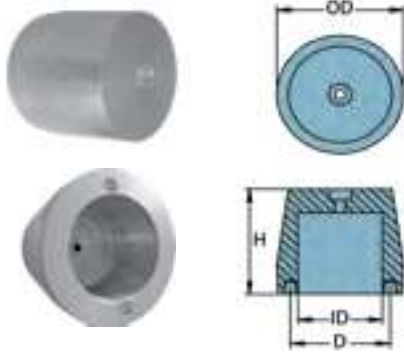

	PID	LB	KG		OD	ID	D	H	UPC
Al	CMOU686A	5.88	2.67	mm	140	93	110	125	6 28309 24227 5
Mg	CMOU686M	3.72	1.69						6 28309 24360 9
Zn	CMOU686Z	15.36	6.97	in	5.51	3.66	4.33	4.92	6 28309 24139 1

SPLENDIDA 72

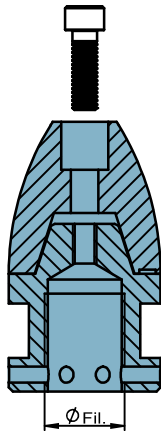

	PID	LB	KG	Shaft	Ø Fil.	UPC
Zn	CMRV221615Z	0.82	0.37	22-25	16 X 1.5	6 28309 24144 5
Zn	CMRV221620Z	0.49	0.22	22-25	16 X 2	6 28309 24145 2
Al	CMRV2518175A	0.672	0.305	25	18 X 1.75	6 28309 23807 0
Mg	CMRV2518175M	0.628	0.285	25	18 X 1.75	6 28309 23808 7
Zn	CMRV2518175Z	0.871	0.395	25	18 X 1.75	6 28309 23809 4
Al	CMRV251815A	0.668	0.303	25	18 X 1.5	6 28309 23804 9
Mg	CMRV251815M	0.624	0.283	25	18 X 1.5	6 28309 23805 6
Zn	CMRV251815Z	0.866	0.393	25	18 X 1.5	6 28309 23806 3
Zn	CMRV251820Z	0.82	0.37	25	18 X 2	6 28309 24146 9
Al	CMRV302015A	0.650	0.295	30	20 X 1.5	6 28309 24252 7
Mg	CMRV302015M	0.606	0.275	30	20 X 1.5	6 28309 24381 4
Zn	CMRV302015Z	0.848	0.385	30	20 X 1.5	6 28309 24147 6
Zn	CMRV352420Z	2.76	1.25	35	24 X 2	6 28309 24148 3
Zn	CMRV402620Z	2.16	0.98	40	26 X 2	6 28309 24149 0
Zn	CMRV2230	0.82	0.37	22-30	-	6 28309 24432 3
Zn	CMRV3550	2.20	1.40	35-50	-	6 28309 24433 0

Martyr®
PROPELLER ANODES

INTERNAL SQUARE ANODES

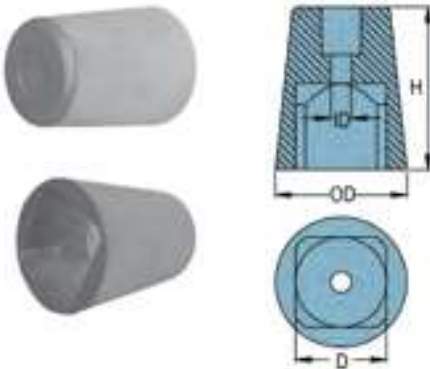

	PID	LB	KG		OD	ID	H	D	UPC
Al	CMIQ648A	0.826	0.375	mm	68	11	85	47	6 28309 23673 1
Mg	CMIQ648M	0.524	0.238						6 28309 23674 8
Zn	CMIQ648Z	2.156	0.978	in	2.68	0.43	3.35	1.85	6 28309 23675 5

SHAFRAN™ ANODES

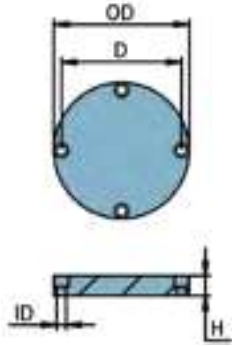

	PID	LB	KG		OD	D	ID	H	UPC
Al	CMSH579A	1.922	0.872	mm	148	80	12	20	6 28309 23912 1
Mg	CMSH579M	1.219	0.553						6 28309 23918 3
Zn	CMSH579Z	5.011	2.273						6 28309 23906 0
Al	CMSH587A	1.922	0.872	in	5.8	3.1	0.47	0.8	6 28309 23913 8
Mg	CMSH587M	1.219	0.553						6 28309 23919 0
Zn	CMSH587Z	5.011	2.273						6 28309 23907 7
Al	CMSH649A	1.636	0.742	mm	135	115	8	20	6 28309 23914 5
Mg	CMSH649M	1.036	0.470						6 28309 23920 6
Zn	CMSH649Z	4.266	1.935						6 28309 23908 4
Al	CMSH650A	2.149	0.975	mm	140	110	12	25	6 28309 23915 2
Mg	CMSH650M	1.362	0.618						6 28309 23921 3
Zn	CMSH650Z	5.604	2.542						6 28309 23909 1
Al	CMSH651A	1.697	0.770	mm	125	105	12	25	6 28309 23916 9
Mg	CMSH651M	1.076	0.488						6 28309 23922 0
Zn	CMSH651Z	4.424	2.007						6 28309 23910 7
Al	CMSH732A	3.172	1.439	mm	169	150	12	25	6 28309 23917 6
Mg	CMSH732M	2.010	0.912						6 28309 23923 7
Zn	CMSH732Z	8.271	3.752						6 28309 23911 4

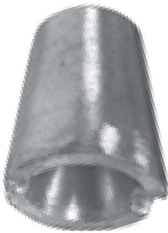
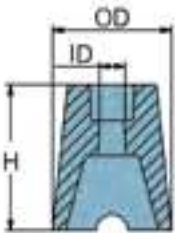

SOLE™ ANODES

	PID	LB	KG		OD	ID	H	UPC
Al	CMPNSOLE1A	0.088	0.040	mm	32	7	39	6 28309 19277 8
Mg	CMPNSOLE1M	0.061	0.028					6 28309 19316 4
Zn	CMPNSOLE1	0.233	0.106					6 28309 16033 3
Al	CMPNSOLE2A	0.161	0.073	in	1.26	0.26	1.5	6 28309 19278 5
Mg	CMPNSOLE2M	0.101	0.046					6 28309 19317 1
Zn	CMPNSOLE2	0.441	0.200					6 28309 16034 0
Al	CMPNSOLE3A	0.308	0.140	mm	45	9	60	6 28309 19279 2
Mg	CMPNSOLE3M	0.200	0.091					6 28309 19318 8
Zn	CMPNSOLE3	0.793	0.360					6 28309 16035 7
Al	CMPNSOLE4A	0.518	0.235	mm	55	9	70	6 28309 19280 8
Mg	CMPNSOLE4M	1.124	0.510					6 28309 19319 5
Zn	CMPNSOLE4	1.322	0.600					6 28309 16036 4

PLEASURECRAFT

PROP NUT &

BOW THRUSTER

A N O D E S

AZIMUT - BENETTI™ ANODES

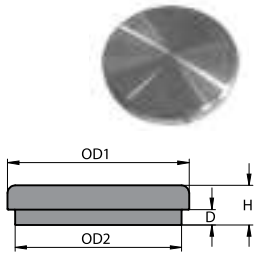

	PID	LB	KG		H	D	OD1	OD2	UPC
Al	CMAZM14347A	3.969	1.80	mm	47	18	143	127	6 28309 27051 3
Zn	CMAZM14347Z	10.364	4.70	in	1.85	0.71	5.63	5.0	6 28309 27050 8



	PID	LB	KG		H	D	OD1	OD2	UPC
Al	CMAZM24052A	12.789	5.80	mm	52	20	240	220	6 28309 27048 3
Zn	CMAZM24052Z	33.516	15.20	in	2.05	0.79	9.45	8.66	6 28309 27047 8

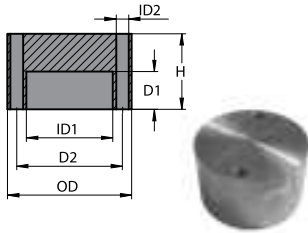

	PID	LB	KG		H	D1	D2	OD	ID1	ID2	UPC
Al	CMAZM164100A	9.04	4.10	mm	100	50	140	164	114	16.5	6 28309 27054 4
Zn	CMAZM164100Z	23.81	10.80	in	3.94	1.97	5.51	6.46	4.49	0.65	6 28309 27053 7

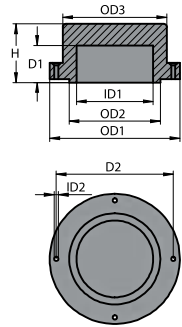

	PID	LB	KG		H	D1	D2	OD1	OD2	OD3	ID1	ID2	UPC
Al	CMAZM16057A	8.38	3.80	mm	90	57	180	200	140	160	118	6.5	6 28309 27057 5
Zn	CMAZM16057Z	22.05	10.0	in	3.54	2.24	7.09	7.87	5.51	6.30	4.65	0.26	6 28309 27056 8

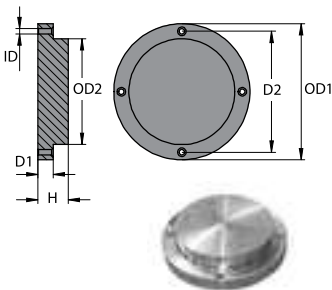

	PID	LB	KG		H	D1	D2	OD1	OD2	ID	UPC
Al	CMAZM18040A	4.63	2.10	mm	40	20	160	180	140	7	6 28309 27060 5
Zn	CMAZM18040Z	12.35	5.60	in	1.57	0.79	6.30	7.09	5.51	0.28	6 28309 27059 9

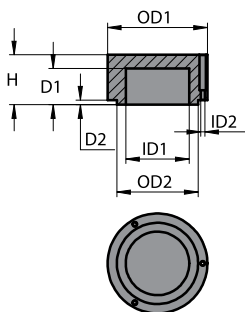

	PID	LB	KG		H	D1	D2	OD1	OD2	ID1	ID2	UPC
Al	CMAZM220110A	16.32	7.40	mm	110	80	10	220	179	140	9	6 28309 27508 2
Zn	CMAZM220110Z	42.56	19.30	in	4.33	3.15	0.39	8.66	7.05	5.51	0.35	6 28309 27504 4

PROP NUT AND BOW THRUSTER ANODES

**NEW
PRODUCTS**

Choose
Aluminum

Al premium
SALT AND BRACKISH WATER

Anodes for
salt and brackish
water and
Magnesium

Mg fresh
FRESH WATER ONLY

for freshwater.

CODECASA™ ANODES

	PID	LB	KG		H	D1	D2	D3	OD	ID1	ID2	ID3	ID4	UPC
Al	CMCOD12090A	4.41	2.0	mm	90	30	5	35	120	88	55	26	12.5	28309 27069 8
Zn	CMCOD12090Z	11.69	5.30	in	3.54	1.18	0.20	1.38	4.72	3.46	2.17	1.02	0.49	28309 27068 1

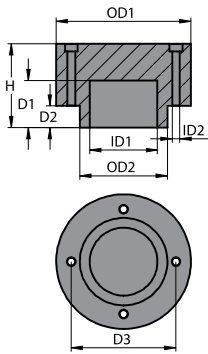
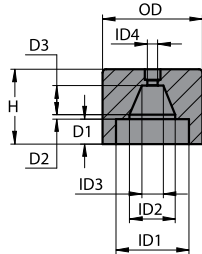

	PID	LB	KG		H	D1	D2	D3	OD1	OD2	ID1	ID2	UPC
Al	CMCOD18083A	11.69	5.30	mm	112	63	29	140	180	117	90.5	10.5	28309 27066 7
Zn	CMCOD18083Z	30.43	13.80	in	4.41	2.48	1.14	5.51	7.09	4.61	3.56	0.41	28309 27065 0



LEOPARD™ ANODES

	PID	LB	KG		H	D1	D2	D3	OD	ID1	ID2	UPC
Al	CMLEP7060A	0.884	0.401	mm	60	8.5	31	30	70	46	8.5	28309 27078 0
Zn	CMLEP7060Z	2.306	1.046	in	2.36	0.33	1.22	1.18	2.76	1.81	0.33	28309 27077 3

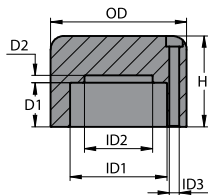
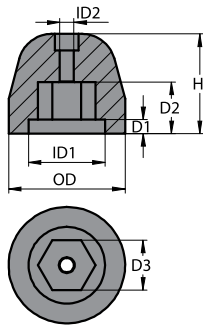

	PID	LB	KG		H	D1	D2	OD	ID1	ID2	ID3	UPC
Al	CMLEP9060A	1.577	0.715	mm	60	29	5	90	64	45	6.5	28309 27509 9
Zn	CMLEP9060Z	4.110	1.864	in	2.36	1.14	0.20	3.54	2.52	1.77	0.26	28309 27505 1

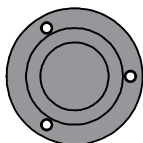

Martyr®
PROP NUT AND BOW THRUSTER ANODES

LEWMAR™ ANODES

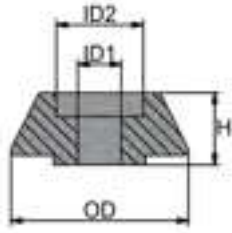

	PID	LB	KG		H	OD	ID1	ID2	UPC
Al	CM589150A	0.068	0.031	mm	14	38	8	18	6 28309 23368 6
Mg	CM589150M	0.048	0.022						6 28309 23372 3
Zn	CM589150Z	0.163	0.074						6 28309 23373 0
Al	CM589350A	0.099	0.045	in	0.6	1.5	0.33	0.7	6 28309 23374 7
Mg	CM589350M	0.068	0.031						6 28309 23378 5
Zn	CM589350Z	0.231	0.105						6 28309 23379 2
Al	CM589550A	0.227	0.103	mm	20	60	17	34	6 28309 23380 8
Mg	CM589550M	0.156	0.071						6 28309 23384 6
Zn	CM589550Z	0.540	0.245						6 28309 23385 3

LEWMAR™ ANODE KITS



	PID	LB	KG	Contains	Fits	UPC
Al	CM589150KITA	0.222	0.101	CM589150×1	Lewmar 140TT Thruster 589150	6 28309 23369 3
Mg	CM589150KITM	0.203	0.092			6 28309 23370 9
Zn	CM589150KITZ	0.317	0.144			6 28309 23371 6



	PID	LB	KG	Contains	Fits	UPC
Al	CM589350KITA	0.277	0.126	CM589350×1	Lewmar 185TT Thruster 589350	6 28309 23375 4
Mg	CM589350KITM	0.260	0.118			6 28309 23376 1
Zn	CM589350KITZ	0.410	0.186			6 28309 23377 8



	PID	LB	KG	Contains	Fits	UPC
Al	CM589550KITA	0.749	0.340	CM589550×2	Lewmar 250/300TT Thruster 589550	6 28309 23381 5
Mg	CM589550KITM	0.613	0.278			6 28309 23382 2
Zn	CM589550KITZ	1.371	0.622			6 28309 23383 9

Choose
Aluminum

Al premium
SALT AND BRACKISH WATER

Anodes for
salt and brackish
water and
Magnesium

Mg fresh
FRESH WATER ONLY

for freshwater.

MAX POWER™ ANODES

	PID	LB	KG		H	OD	ID	UPC
Al	CMMP586A	0.079	0.036	mm	32	32	7	6 28309 21500 2
Mg	CMMP586M	0.050	0.023					6 28309 21501 9
Zn	CMMP586Z	0.205	0.093	in	1.3	1.3	0.26	6 28309 21502 6

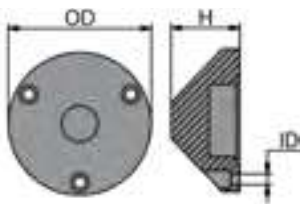
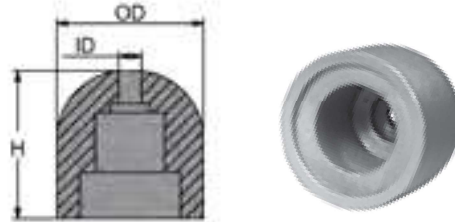

	PID	LB	KG		H	OD	ID	UPC
Al	CMMP676A	0.416	0.189	mm	38	79	6	6 28309 23730 1
Mg	CMMP676M	0.264	0.120					6 28309 23731 8
Zn	CMMP676Z	1.080	0.490	in	1.5	3.1	0.25	6 28309 23732 5



Martyr®

PROP NUT AND BOW THRUSTER ANODES

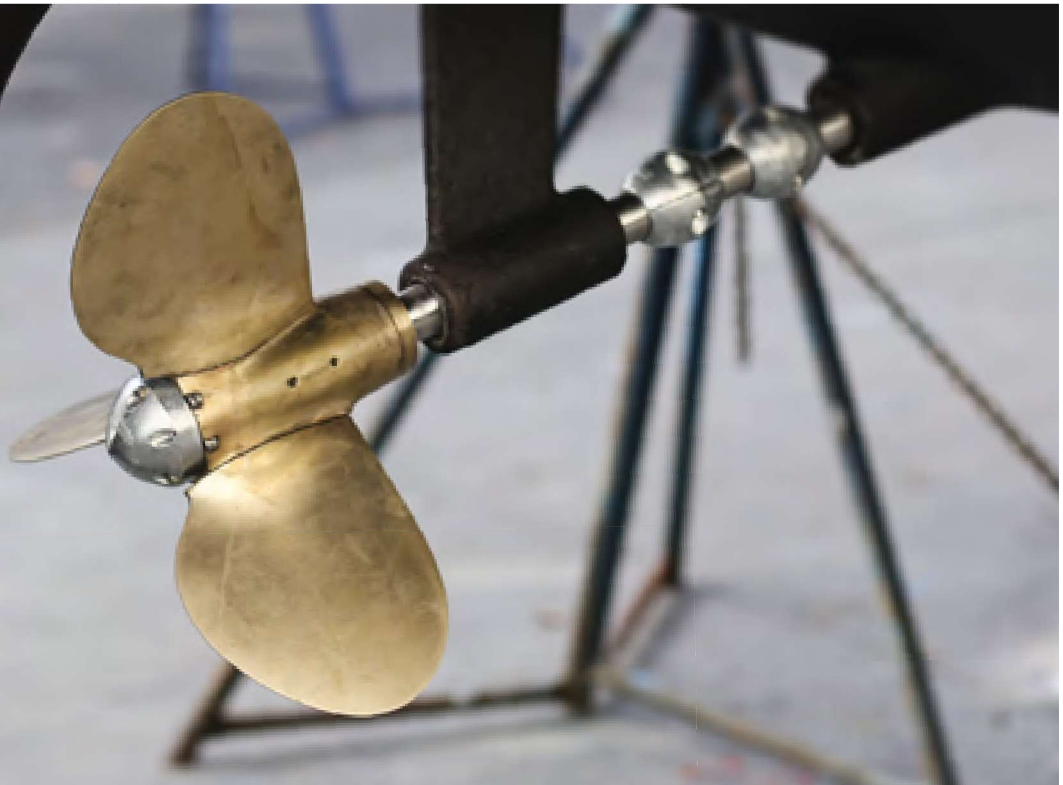

SAN LORENZO™ ANODES

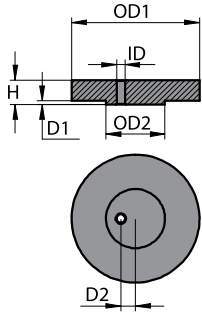

	PID	LB	KG		H	D1	D2	OD1	OD2	ID	UPC
Al	CMSLO13025A	1.680	0.762	mm	25	4	15	130	60	8.5	6 28309 27513 6
Zn	CMSLO13025Z	4.379	1.986	in	0.98	0.16	0.59	5.12	2.36	0.33	6 28309 27506 8

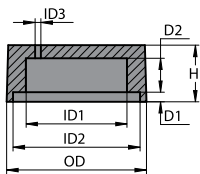

	PID	LB	KG		H	D1	D2	OD	ID1	ID2	ID3	UPC
Al	CMSLO18575A	6.167	2.797	mm	75	13	45	185	134	168	8	6 28309 27081 0
Zn	CMSLO18575Z	16.077	7.291	in	2.95	0.51	1.77	7.28	5.28	6.61	0.31	6 28309 27080 3
Al	CMSLO225130A	13.043	5.915	mm	130	30	75	225	175	205	8.5	6 28309 27087 2
Zn	CMSLO225130Z	33.395	15.145	in	5.12	1.18	2.95	8.86	6.89	8.07	0.33	6 28309 27086 5
Al	CMSLO241130A	17.003	7.711	mm	130	30	75	241	171	221	8.5	6 28309 27080 2
Zn	CMSLO241130Z	44.309	20.095	in	5.12	1.18	2.95	9.49	6.73	8.70	0.33	6 28309 27089 6

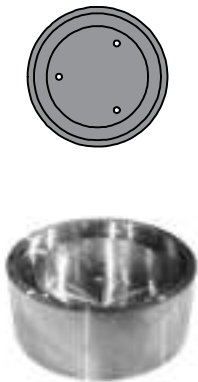

	PID	LB	KG		H	D1	D2	D3	OD	ID1	ID2	ID3	ID4	UPC
Al	CMSLO19090A	6.928	3.142	mm	90	10	25	35	190	135	170	175	8	6 28309 27514 3
Zn	CMSLO19090Z	18.057	8.189	in	3.54	0.39	0.98	1.38	7.48	5.31	6.69	6.89	0.31	6 28309 27507 5

